



ECCELLENZA TOUCH™ CLEANING & STARTUP PROCEDURE

This procedure demonstrates how to properly clean
and sanitize the Eccellenza Touch™ brewer

This procedure should take approximately 60 minutes

Tools Needed

- ◆ Keurig® Bean to Cup Deep Cleaning kit (*if available*)
- ◆ Large bucket or container
- ◆ Available sink
- ◆ Slotted screwdriver
- ◆ Key to main door
- ◆ Small paint brush



Table of Contents

Disconnecting & Draining	Pg. 3
Removing the Brewer Assembly	Pg. 4
Removing the Coffee Hopper	Pg. 5
Removing the Powder System	Pg. 6 - 9
Cleaning & Sanitizing Procedure	Pg. 10
Cleaning Interior & Exterior Components	Pg. 11
Reinstalling the Powder System	Pg. 12
Reinstalling the Brewer Assembly	Pg. 13
Reinstalling the Coffee Hopper	Pg. 14
Restarting & Refilling	Pg. 15
How to Perform Both Cleanings & Rinses	Pg.'s 16 - 20
Performing Test Brews	Pg. 21

Note: Cleaning: *Refers to generally wiping down/removing debris or spills from surfaces.*
Sanitization: *Refers to using a disinfecting solution, wipe, or a cloth with disinfectant on it to help eliminate contaminants and germs.*

Disconnecting & Draining

Turn power switch to O position and unplug from grounded outlet.



Turn machine around to access back cover and remove 4 screws and lift back cover up and away from machine.

Note: Water supply may need to be disconnected to achieve above step.

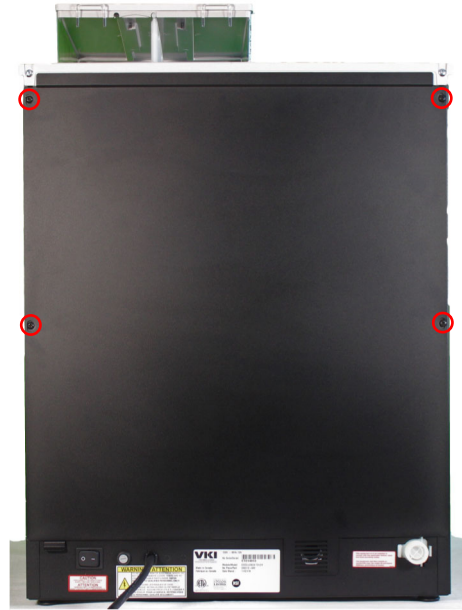

Locate drain hose, open valve, drain hot water into a large bucket or water-tight container then close valve and restow.

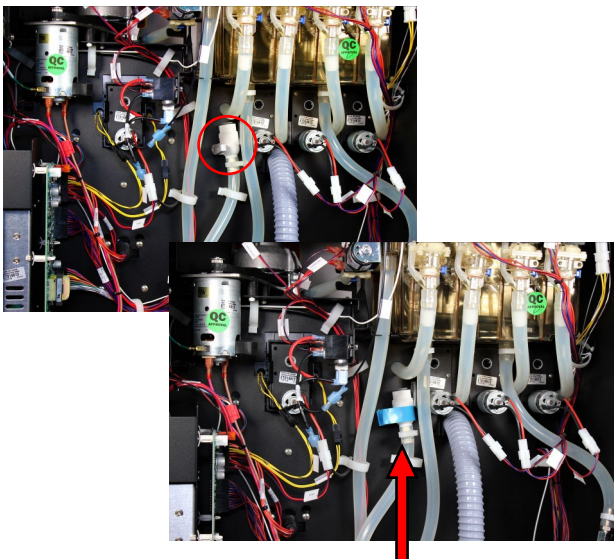
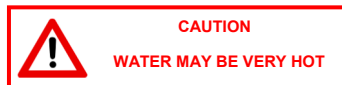

Shown with factory installed tape

Replace back panel with the 4 screws.

Note: Ensure back panel lower tabs are inserted correctly.



Removing the Brewer Assembly

Turn machine back around to front.
Remove waste container, empty & clean.



Insert key and turn counterclockwise then open
main door.



Remove coffee spout from
front of brewer assembly.



Remove brewer assembly by
pressing red button and turning
to the clockwise while lifting.



Carefully remove wiper and
thoroughly clean exterior of
both parts.

NOTE: Brewer assembly cleaning
instructions can be found on page
17.



Removing the Coffee Hopper

LOOSEN ONLY the two screws beneath the coffee hopper.

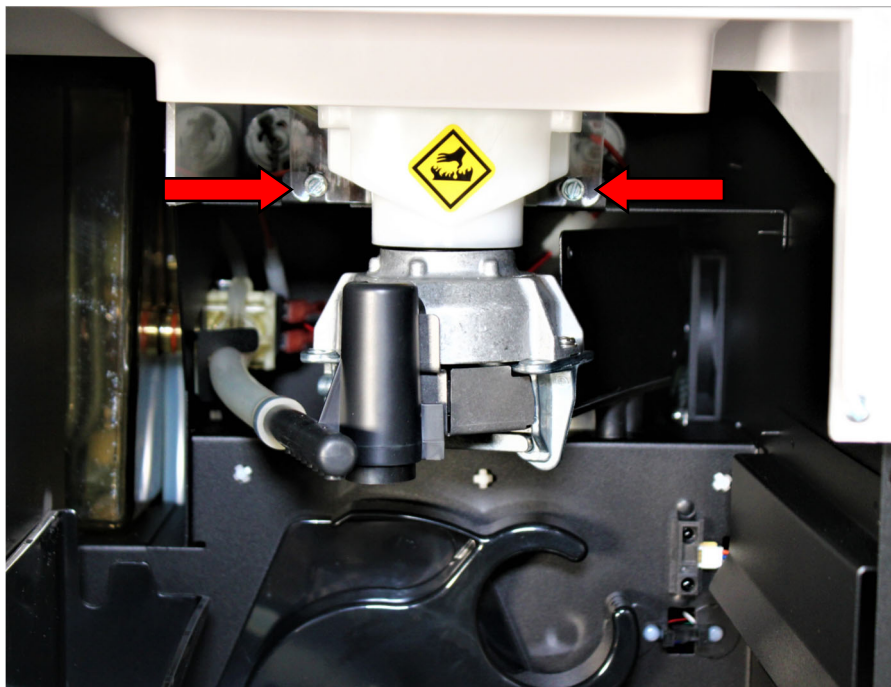

Lift coffee hopper from unit and remove.

If necessary, discard coffee beans and wipe down or thoroughly clean.

NOTE: See cleaning instructions on page 11.



Removing the Powder System

Disconnect hoses to mixing chambers.



Unlock and remove mixing chambers.

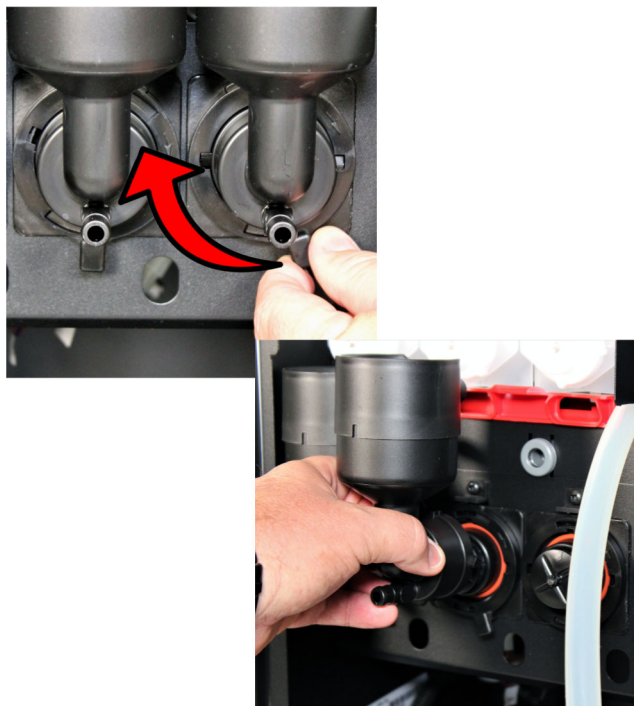

Remove mixing disks by sliding forward from the whipper motor shaft.

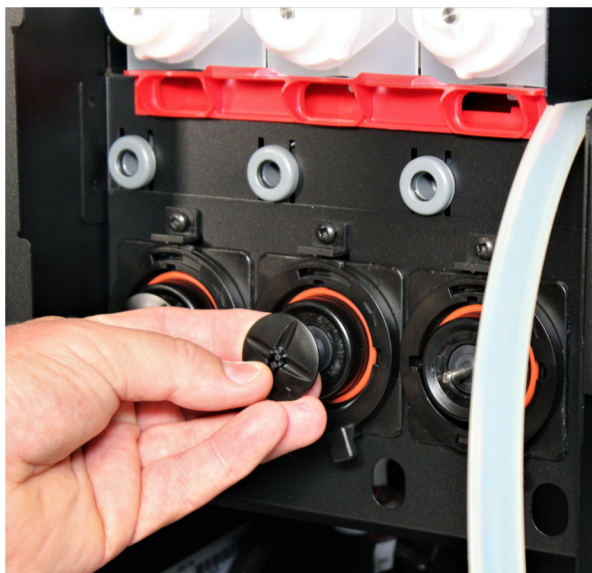

Remove locking rings.



Removing the Powder System *cont.*

Grab and pull towards you to remove powder drawer.



Lift powder lid.

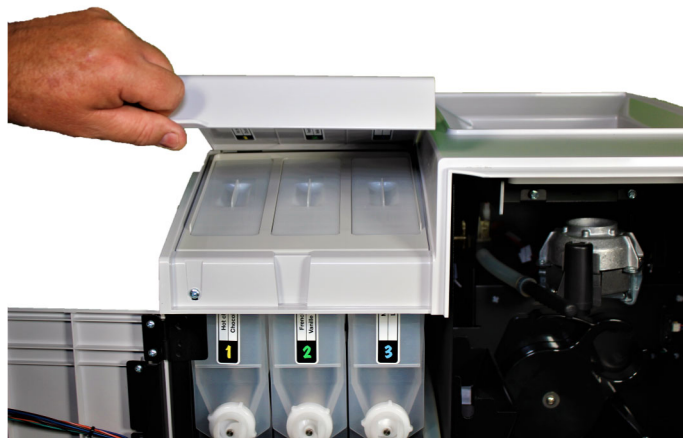

Remove powder hopper caps.



Carefully remove powder hopper liner.

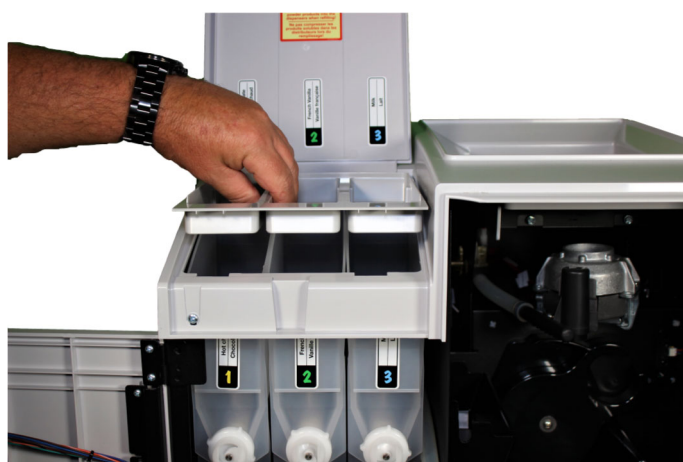

Removing the Powder System *cont.*

Disconnect hot water hose and all hoses.



Clean and sanitize all removed powder system parts in accordance with the Cleaning & Sanitizing procedure on page 11.

NOTE: We recommend cleaning and sanitizing all parts with Urnex® products from the Keurig® Bean to Cup Deep Cleaning Kit, but comparable agents may also be used



Removing the Powder System *cont.*

Remove and empty powder hoppers.

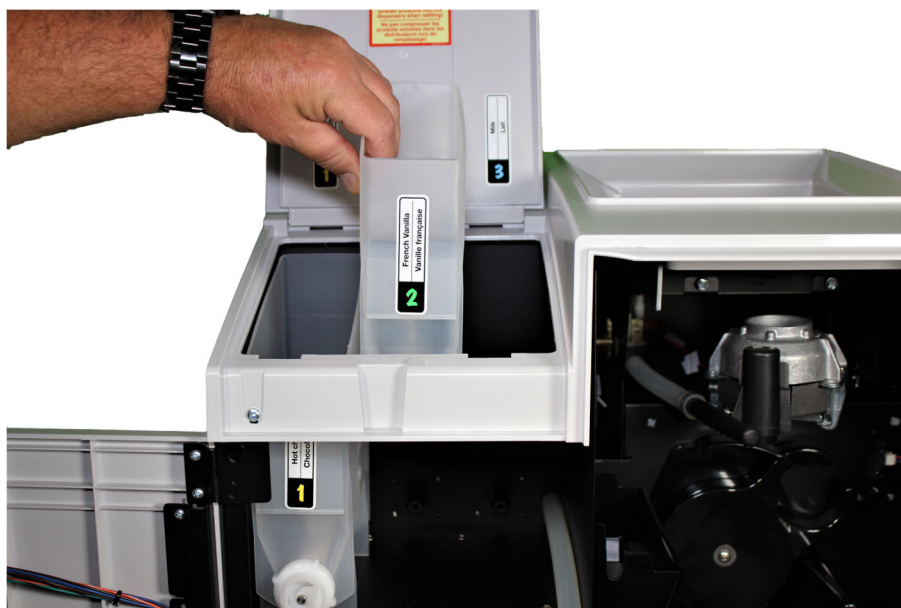

NOTE: If needed, hoppers can be disassembled (shown below) then cleaned and sanitized following instructions on page 11.
Otherwise they can just be refilled following instructions on page 21.

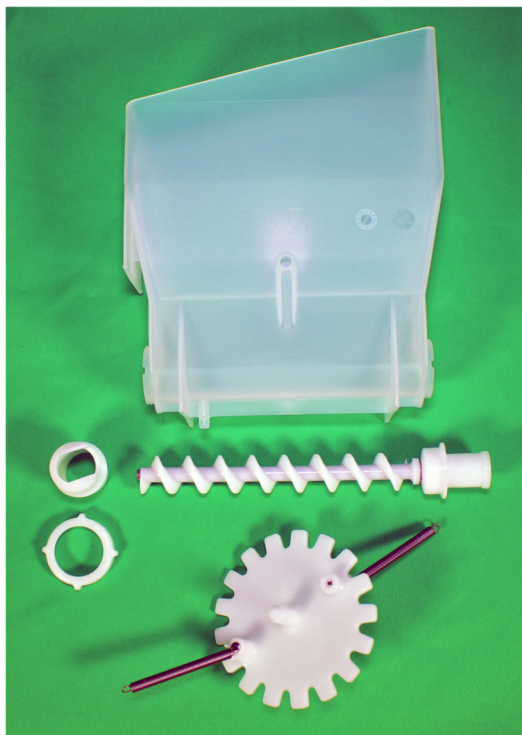

Cleaning Interior & Exterior Components

Wipe interior area around the brewer motor and powder system with a clean cloth dipped in Urnex® Complete Café sanitizer.

NOTE: If available, Urnex® Café Wipz can be used.



Remove and wipe down or clean cup stand & grill using cleaning instructions on page 11.

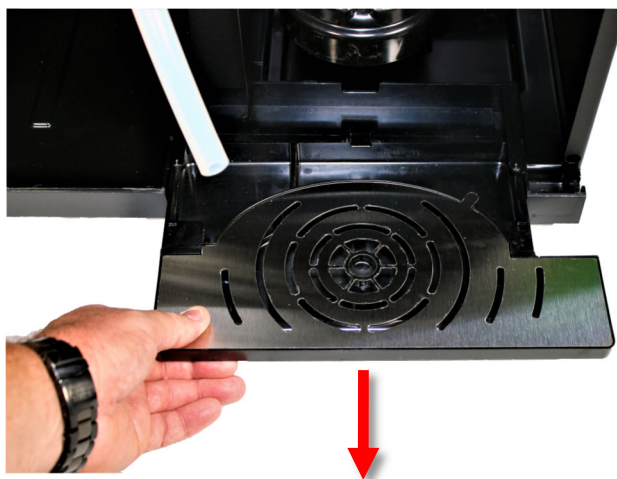

We recommend using the Urnex® Complete Café solution noted on Page 11 on all external surfaces ONLY. But any household or commercial certified disinfectant wipe can be used (following manufacturer's instructions).



Cleaning & Sanitizing Procedure



Cleaning Solution

1. Prepare solution by adding 8 oz (240 ml) of Urnex® Rinza concentrate to 1 gallon (3.5 L) of warm tap water (or equivalent dilution).
2. Mix well and use immediately.
3. Soak removed parts for 30 minutes in solution.
4. Empty bucket and set aside parts to prepare sanitizing solution per the instructions below.

If sanitizing procedure will not be performed, rinse well under clean running water and allow parts to drain and dry completely.

NOTE: For non-removable parts, add cleaning solution to a soft cloth and use it to coat appliance parts. Then let sit for 30 minutes prior to wiping down with sanitizer solution.

Sanitizing Solution

NOTE: Parts must be cleaned prior to sanitizing.

1. Prepare solution by adding 0.5 oz (15 mL) of Urnex® Complete Café concentrate to 1 gallon (3.7 L) of warm tap water.
2. Mix well and use immediately.
3. Soak parts in solution for 1 minute.
4. Remove parts from solution and allow to drain and dry completely.

Do **NOT** rinse or apply water.

If parts were not removed from the appliance, wipe with a clean soft cloth and let air dry.

Sanitizing Spray for Machine Surfaces

NOTE: For non-removable brewer parts and to use on all parts in between sanitizing soaks.

1. Prepare a solution of 4 mL of Urnex® Complete Café Sanitizer to 1 L of water in a spray bottle.
2. Spray exterior surface of appliance and allow solution to remain on surface for 1 minute.
3. Wipe away with clean cloth and allow to fully air dry.

Urnex® Café Wipz

These can be used to wipe down any components of the brewer that cannot be easily removed

Reinstalling the Powder System

NOTE: Prior to reinstalling powder components, please make sure all components are completely dry

Reinstall powder hoppers.



Carefully reinstall powder hopper liner and caps.

NOTE: Start from one side and move across



Insert powder drawer.



Install locking ring



Carefully reinstall mixing disks.

NOTE: Align arrow with flat spot on motor shaft.

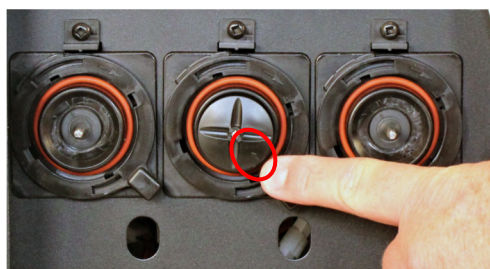

Install mixing bowls and reattach all hoses.

NOTE: Ensure each mixing chamber is secured by checking the tabs at the left & right are not protruding.



Reinstalling the Brewer Assembly

With wiper reinstalled, place brewer assembly with red button slightly turned to 7:00 position.



Press red button and turn counterclockwise until a "click" sound is heard.

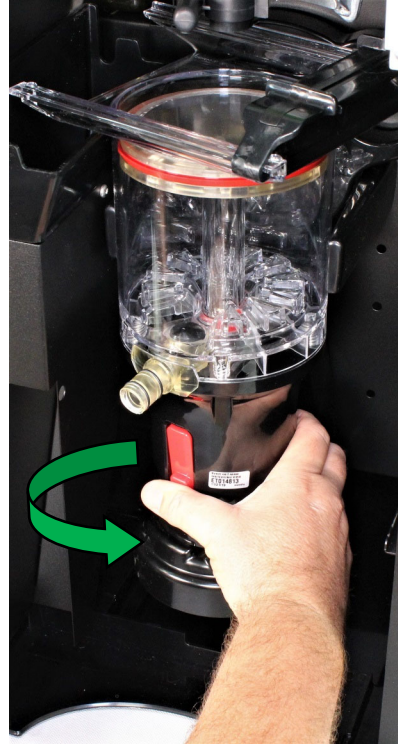

Reattach spout.

NOTE: Ensure that spout is inserted fully past both O-rings to prevent leakage and firmly against brewer assembly body.

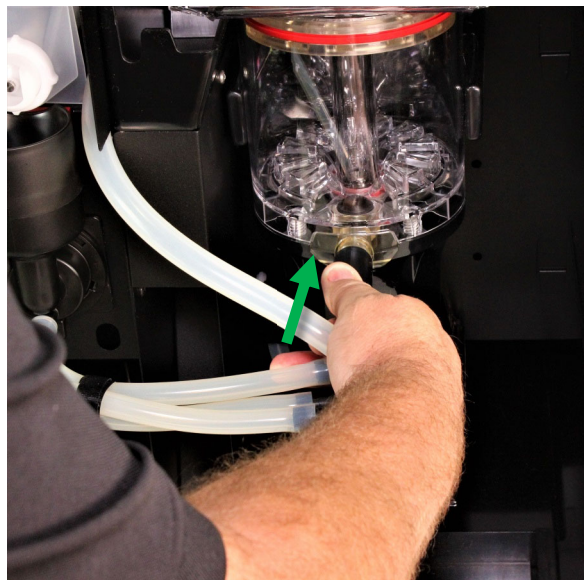

Reinstalling the Coffee Hopper

NOTE: If available, prior to reinstalling the coffee hopper, the grinder can be cleaned using Urnex® SuperGrindz

If available, add 1 cap full (26 grams) of Urnex® SuperGrindz on top of grinder.

NOTE: Grinder cleaning instructions are available on Page 17.



Carefully lower coffee hopper onto grinder.



Tighten the two screws beneath the coffee hopper.

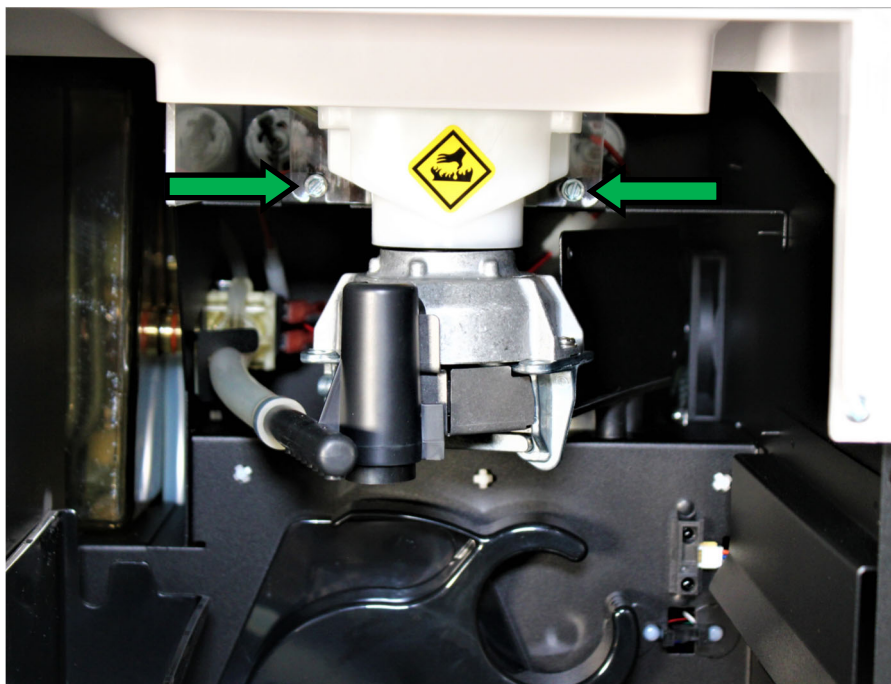

Restarting & Refilling

Close and lock main door.



Reinsert waste container.



Carefully plug GFCI power cord into a grounded outlet.



If disconnected, re-connect water line to Machine and turn power switch to — position.
NOTE: Allow for the machine fill & heat completely.



How to Perform Both Cleanings & Rinses

Press top left of screen, a faint square will light up under your finger, hold for 3 sec.



Enter code: 345678

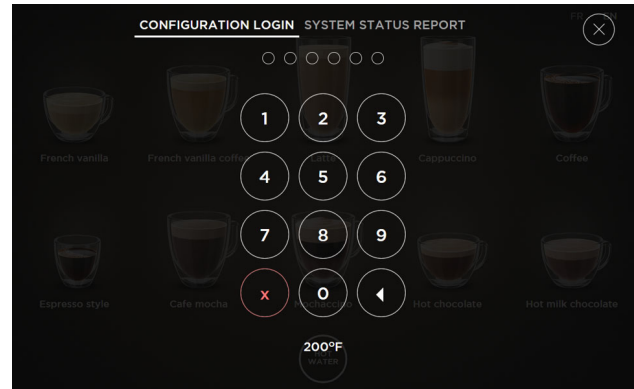

Press 3 lines at top left of screen.

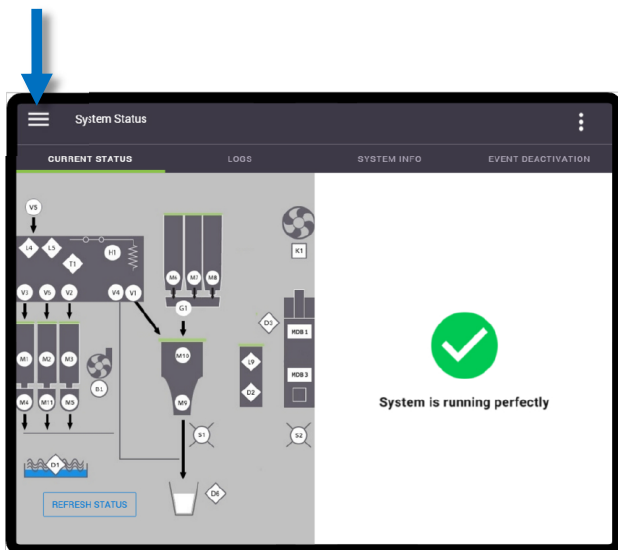

Select Maintenance.

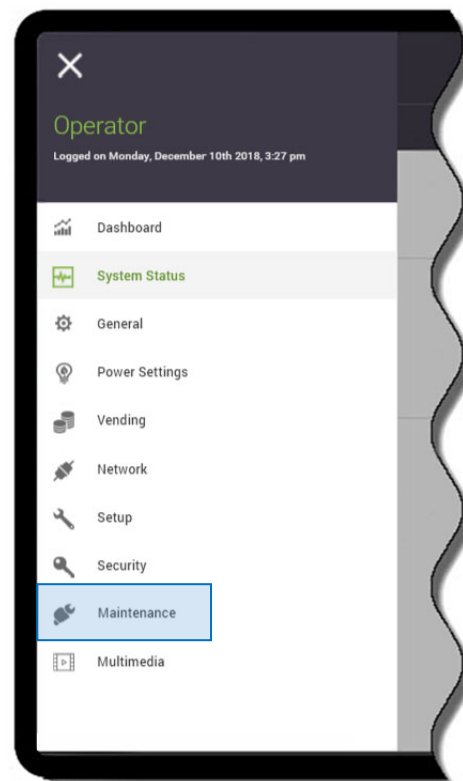

Performing a Grinder Cleaning

NOTE: Please reference page 14 prior to performing the following steps.

Place a 16oz cup on drip tray and press Grinder cleaning.

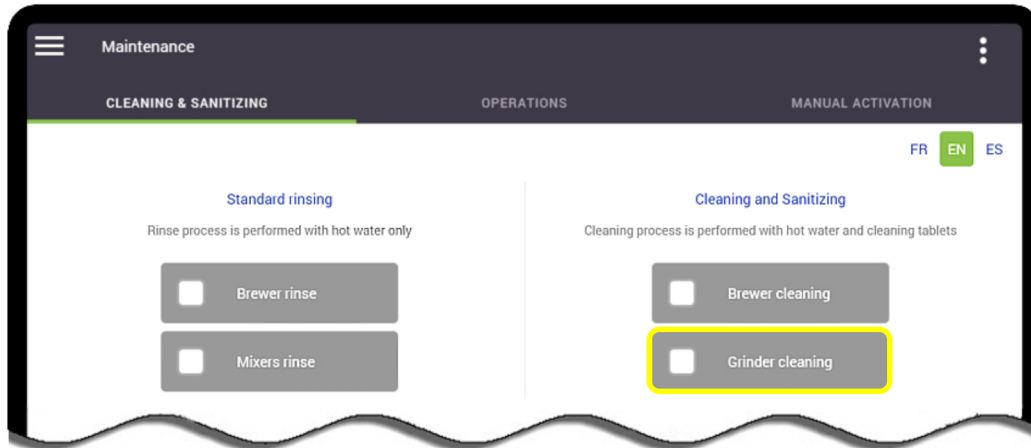

Carefully follow the screen instructions.

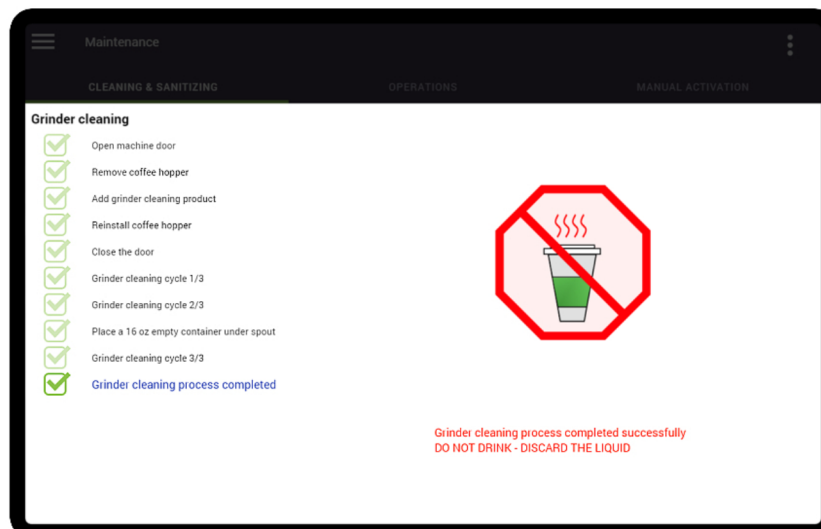
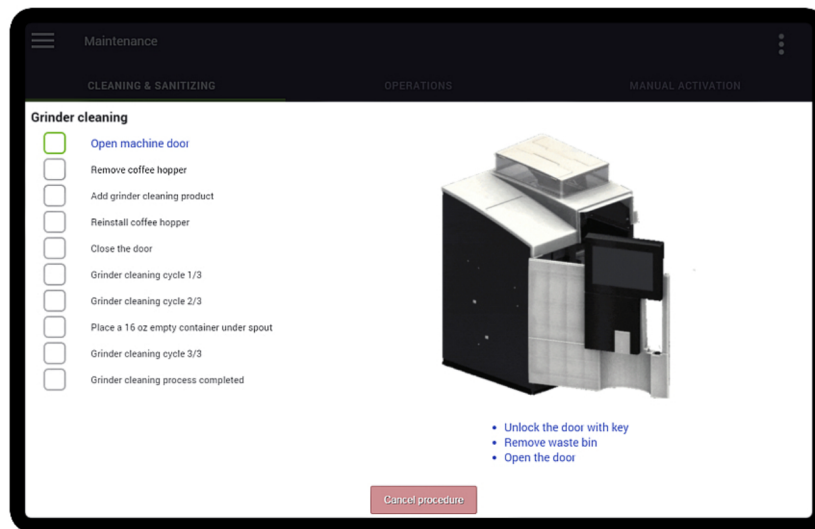

Performing a Brewer Cleaning

NOTE: If a "Brewer Assembly Cleaning Procedure" was done skip following step.

1. Remove waste container.
2. Unlock and open main door.
3. Add 1ea. Urnex® Tabz Z61 cleaning tablet to the top of the brewer assembly.
4. Close and lock main door.
5. Re-insert waste container.



Place a 16oz cup on drip tray and press Brewer cleaning.

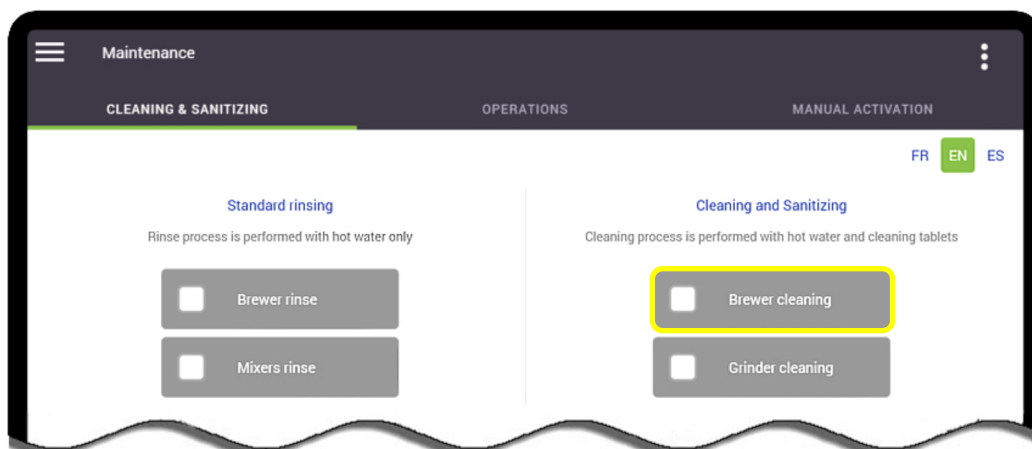

Performing a Brewer Cleaning *cont.*

Carefully follow the screen instructions.

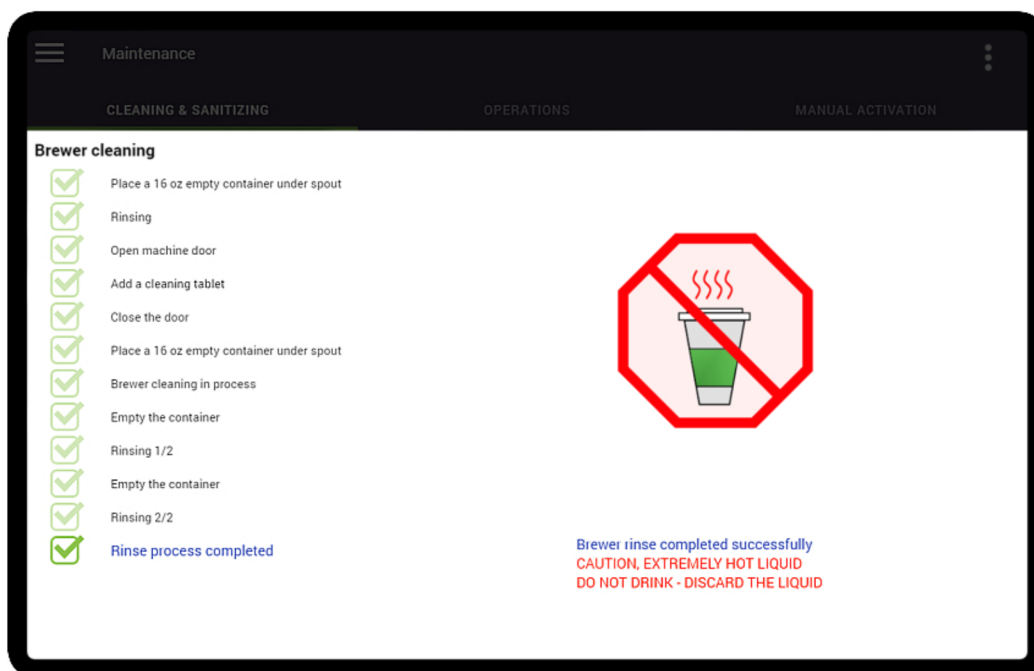
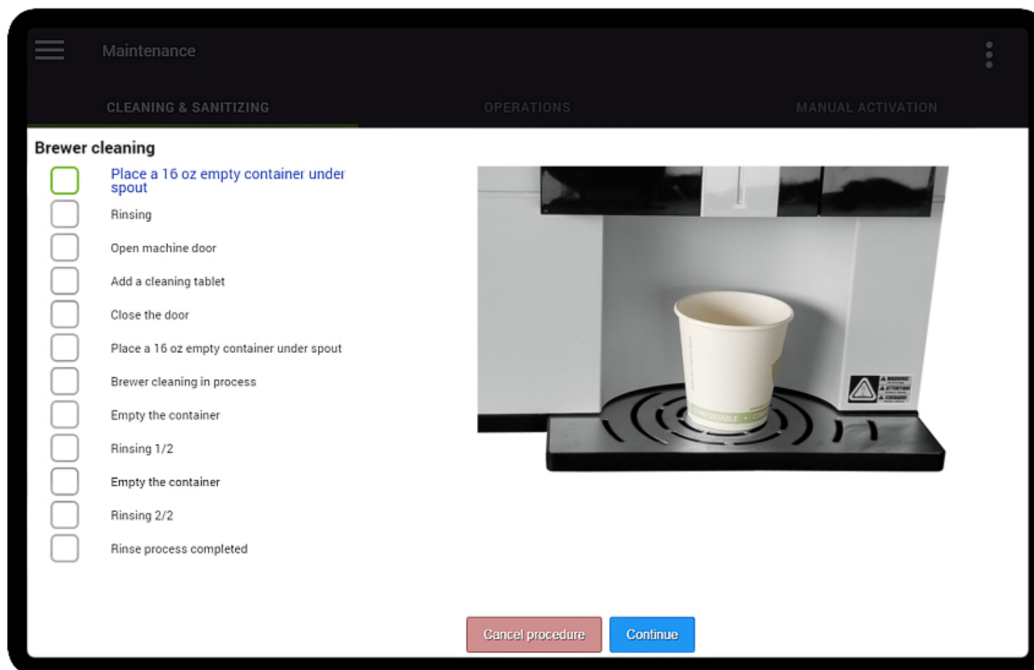

Carefully discard hot liquid.

Performing a Mixers Rinse

Place a 16oz cup on drip tray and press Mixers Rinse

NOTE: Check powder components for any leaks

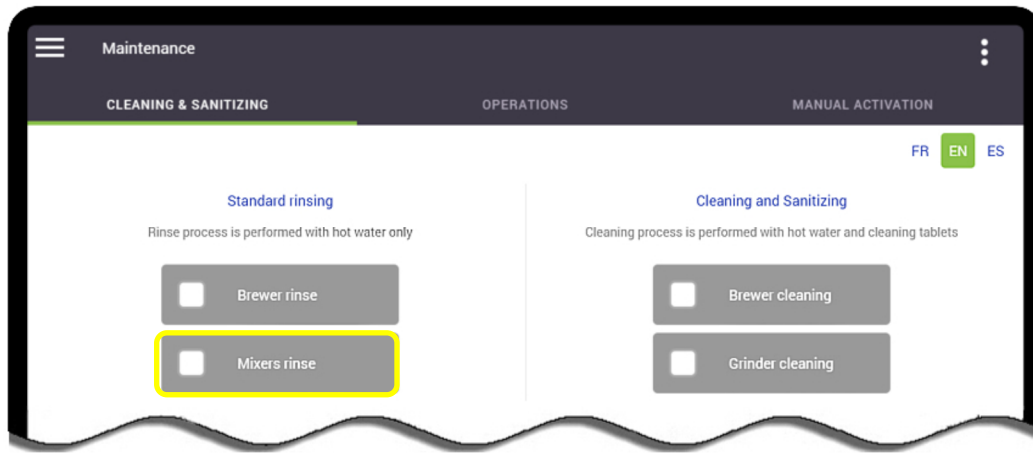

This option runs a rinse cycle (to clean all three of the powder whipper systems) by sending hot water through each of the whipper units, while at the same time activating each of the whipper motors.

This cycle is fully automated and does not require the use of any cleaning agents.

Carefully discard hot liquid.

Exiting the Service Menu

If in the Service Menu, log off by pressing three dots at top right.

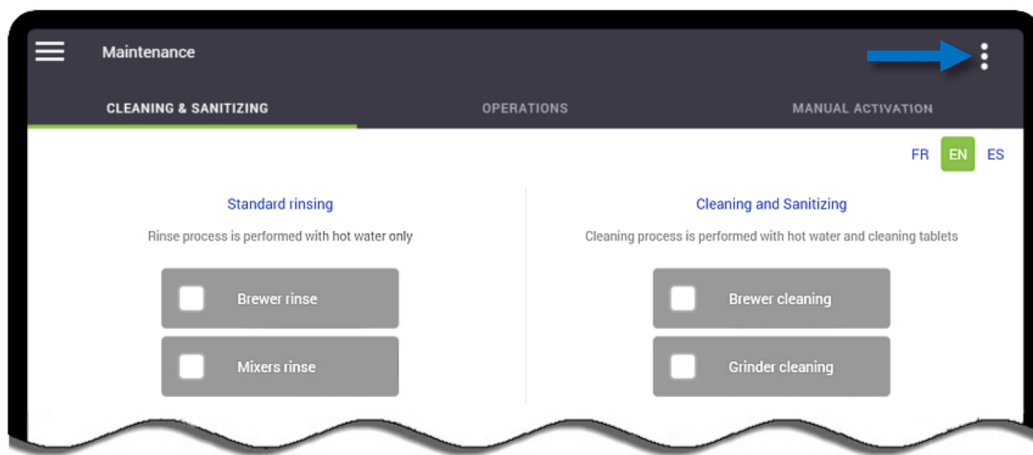

Cleaning the Lower Tray

1. Remove waste container.
2. Unlock and open main door.
3. Remove lower tray (*shown below*) and thoroughly clean then reinsert.
4. Close and lock main door.
5. Re-insert waste container.

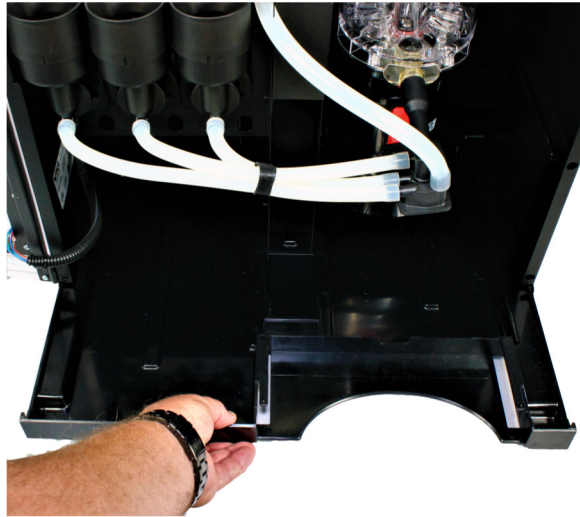

Performing Test Brews

1. Refill coffee hoppers.
2. Refill powder hoppers to level shown below.

NOTE: Do **NOT** overfill or pack powder hoppers.

3. Place a 16oz cup on cup stand and perform a test brew by brewing both a coffee and cappuccino.

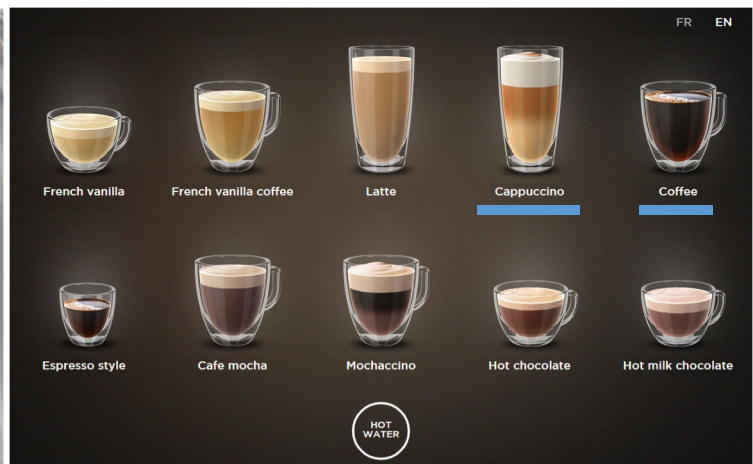
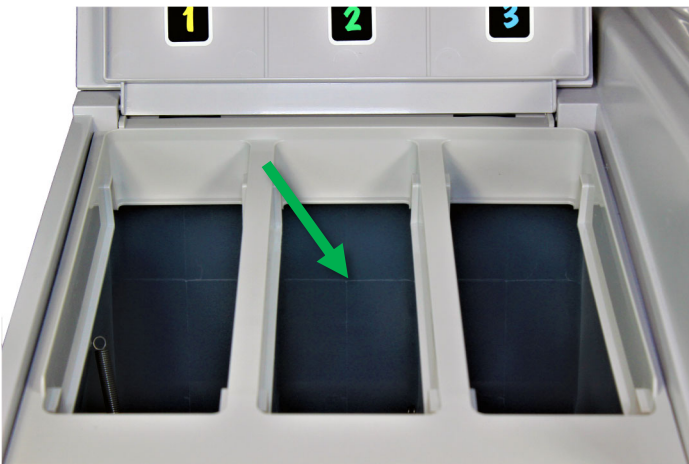

Procedure Complete!

If you have any questions, please contact Keurig® Commercial Technical Support: 888-287-2739 option 5