



DECKING & RAILING PLANNING GUIDE



PLANNING

..... *what's next*

IN OUTDOOR LIVING

Inspired by open skies, fair breezes and sunsets, we find it best to *keep things simple*. This guide will help you get started on the path to a brand-new outdoor living space.

STEP 1 SIZE & SHAPE PG. 4

Whether you need room for a grill or a row of chaise lounge chairs, you'll want to plan the size and shape of your deck around how you'll use it. We'll show you where to start.

STEP 2 SUBSTRUCTURE PG. 8

Though your deck is more than the sum of its parts, some of its parts have to do a little extra lifting. We'll show you how Trex Elevations® steel deck framing stacks up to wood when it comes to even stability and long-lasting support.

STEP 3 SELECT YOUR DECKING PG. 10

With so many colors and grain patterns available, this can be the hardest part of the decision-making process. We compare Trex® vs. wood to help you narrow it down.

STEP 4 CHOOSE YOUR RAILING PG. 16

Your railing design is arguably the best chance to let your style shine, so make sure you don't wait until the last minute to think about it.

STEP 5 ADD THE FINISHING TOUCHES PG. 26

Finally, it's time for the icing on the cake—the furniture, lighting, storage and other bits and bobs that make your deck truly yours. Ready to build? Find a deck builder and your nearest Trex dealer to take it from here.

decking: Transcend in Havana Gold
railing: Reveal in Bronze
also featuring: Trex Outdoor Furniture

STEP 1

SIZE & shape

Every deck starts with a great plan. Once you know how you want to use your deck, you'll be able to determine a good size and shape.

Ask yourself these questions to see where you stand.

- 1 Will you use an existing substructure or build a new one?
- 2 How do you want to design your railing?
- 3 Do you want built-in storage or seating?
- 4 Will there be more than one level?
- 5 Will there be multiple exits and entrances?
- 6 Do you want room for a grill or dining area?
- 7 How much seating space will you need?
- 8 How will you light your deck?

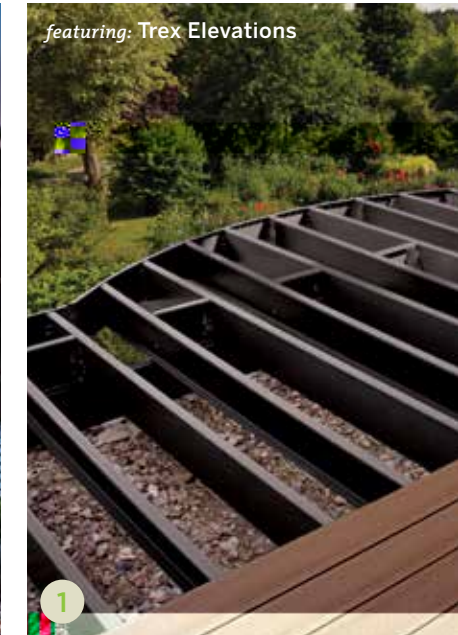
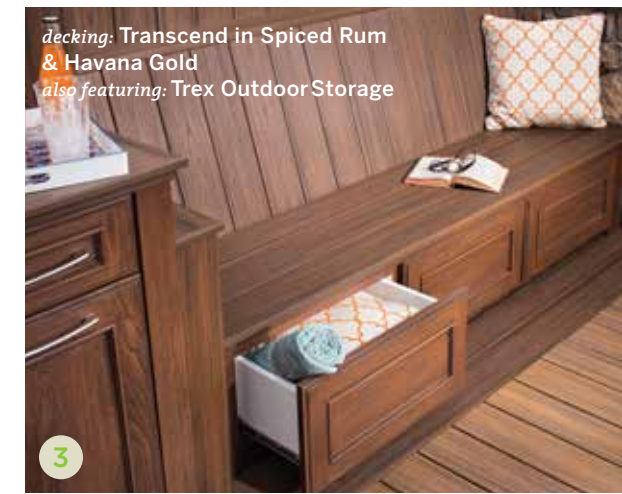
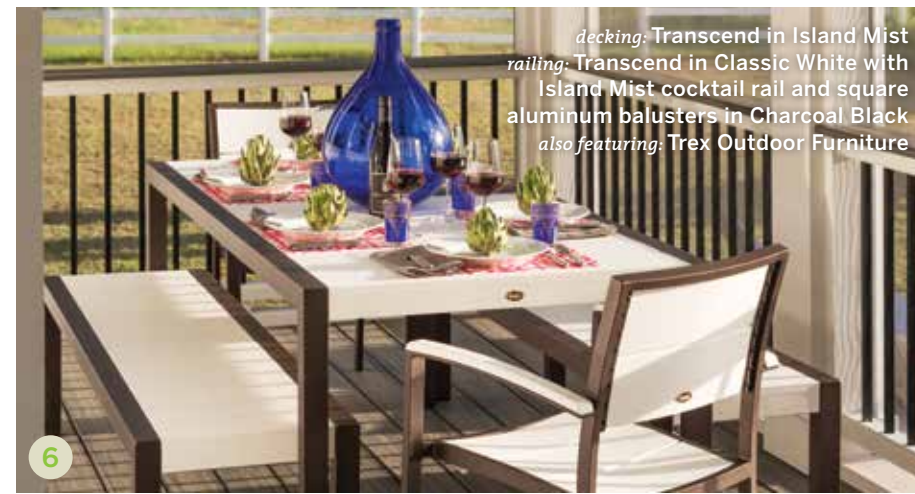

When planning your outdoor space, it's important to make sure your deck has exactly that—space. Check out these popular deck designs, and get more ideas on [trex.com/plans](https://www.trex.com/plans) to find the right deck for you.

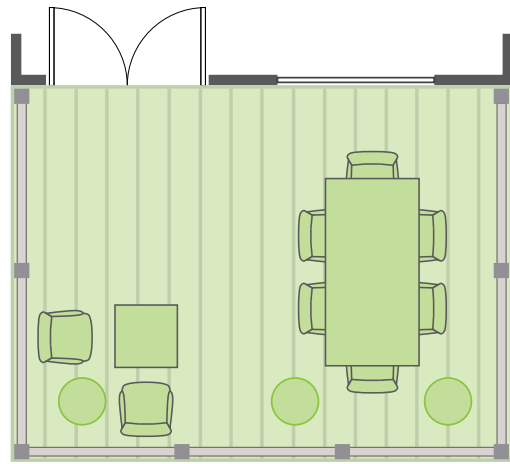

Rectangle Deck

- » Offers room for outdoor eating and grilling
- » Works well with smaller homes, rooftops or side yards
- » Standard shape makes for a versatile, multi-use space

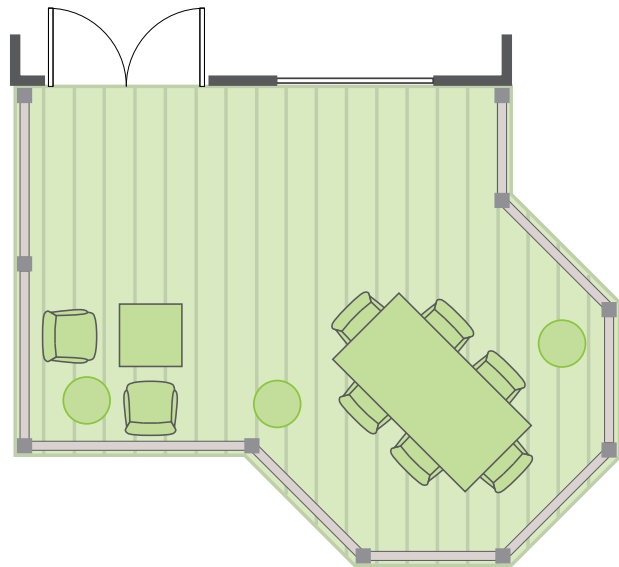

Overlook Deck

- » Provides distinct spaces so you can get the most from your deck
- » Works well with smaller to mid-sized homes with gardens or extended views
- » Multi-side add-on makes for a cozy sitting or dining area

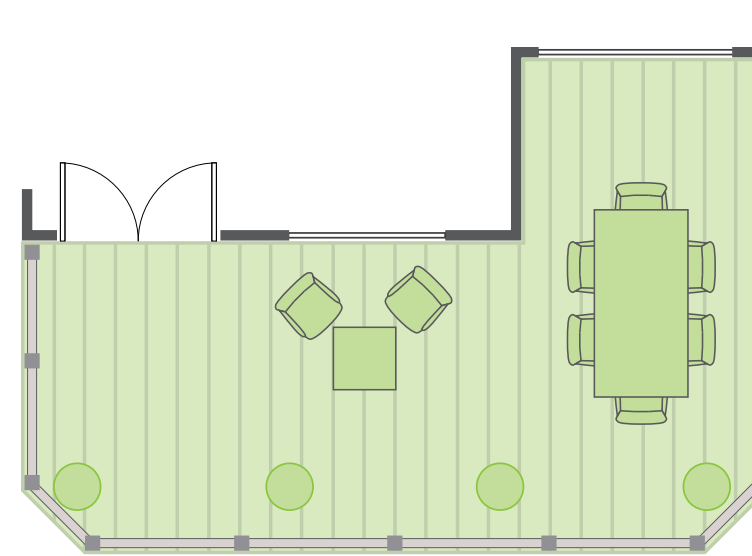

Beveled Edge Deck

- » Allows for large sitting area or several smaller spaces
- » Works well with smaller to mid-sized homes of contemporary design
- » Rounded corners open the view and decor possibilities

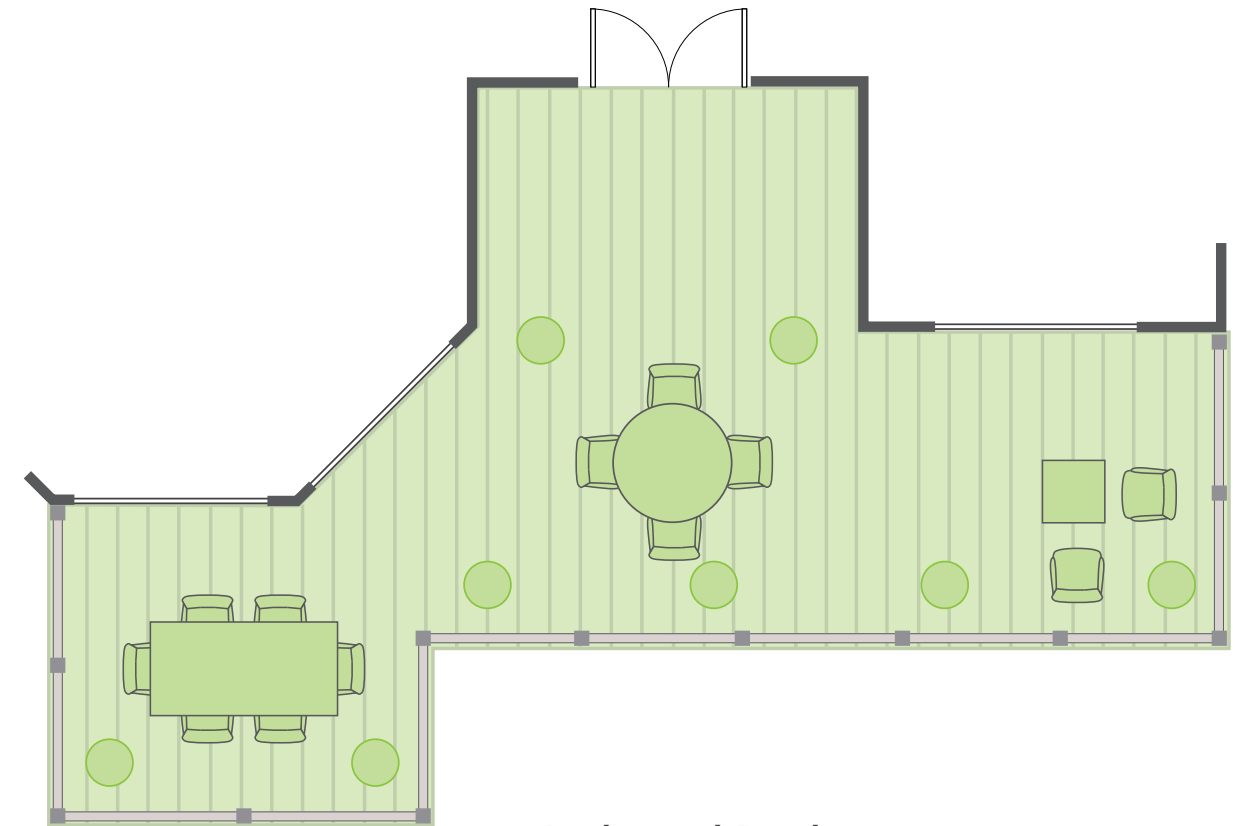

L-shaped Deck

- » Features great space for entertaining guests
- » Works well with large homes and open backyards
- » Easily divided into separate spaces for lounging, dining, grilling and more

SUBSTRUCTURE

*Think about it:
if you're going to invest
in a long-lasting deck,
don't you want its support
to last just as long?*

Even though your deck's substructure may not make the family photos, it's actually the most important part of your new outdoor space. Trex Elevations, our system of durable, triple-coated steel beams, joists and tracks, creates the strongest, straightest and greenest structures down below.

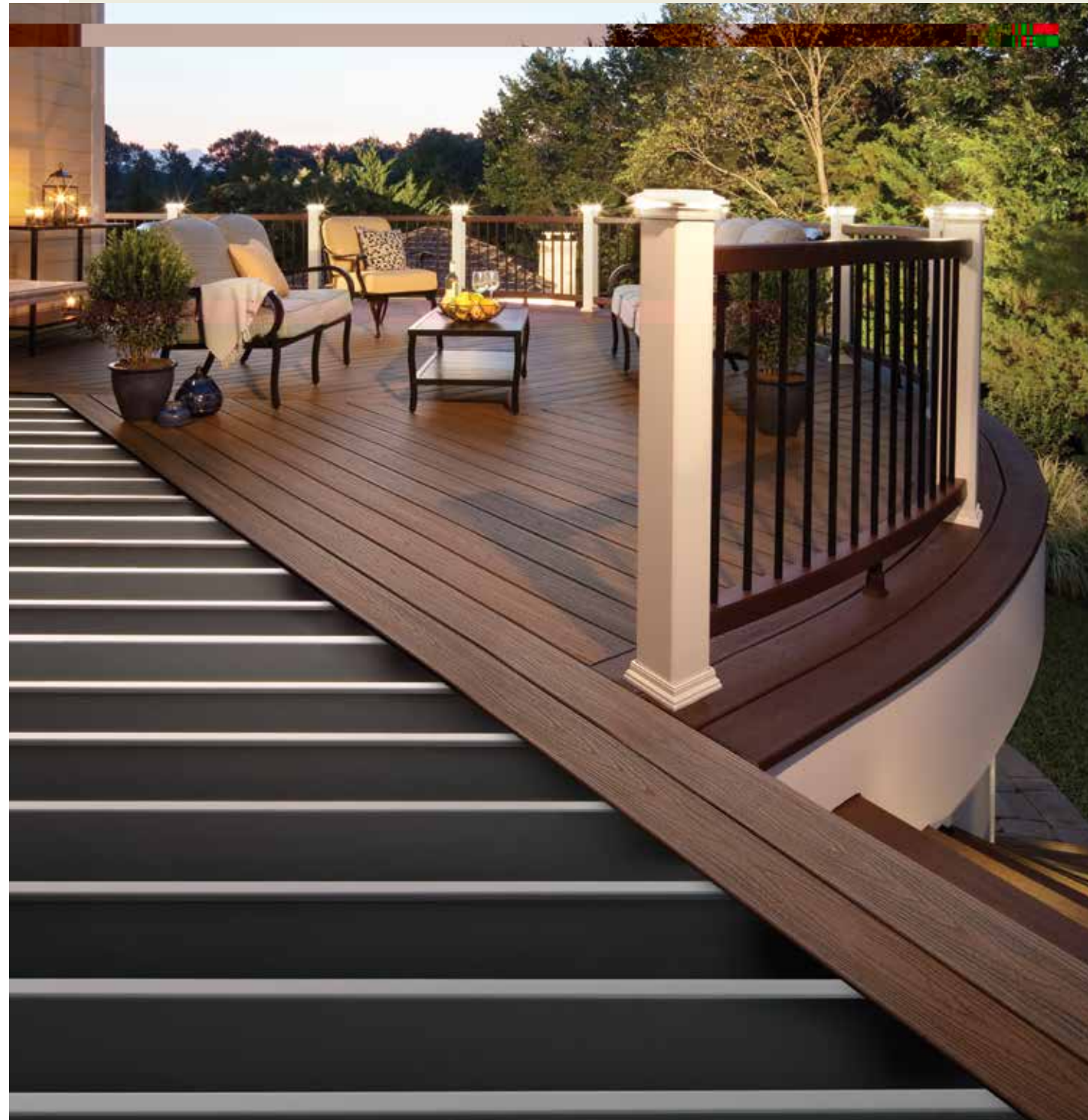

Trex Elevations:

*The only deck frame
that can stand up*

TO THE ELEMENTS

Wood substructures split, warp and shift, leading to an uneven surface in the deck boards above. The dimensionally stable steel of Trex Elevations stays in place, giving you consistently stronger, straighter, safer and smarter decking than what wood can offer.

STRONGER ⚡

Triple-coated steel offers consistency, durability and reliability that wood decks can't

STRAIGHTER ⚡

Precision engineering ensures surfaces remain flat over time

SAFER ⚡

Rot- and termite-proof steel is chemical-free and lasts much longer than wood

SMARTER ⚡

Contains a minimum of 25% recycled steel and is a 100% renewable resource

STEP 3

SELECT *your* DECKING

With high-performance composite decking, you get incredible durability, easy maintenance and long-lasting beauty. That's why high-performance composite is the only type of decking we make. Discover all you can do with Trex that materials like wood can't handle.



MAKE IT LAST

with high-performance shell technology that resists even the worst weather



KEEP IT EFFORTLESS

with easy-to-maintain materials that clean with just soap and water



CREATE LUXURIOUS LOOKS

with authentic wood-grain patterns in vibrant hues

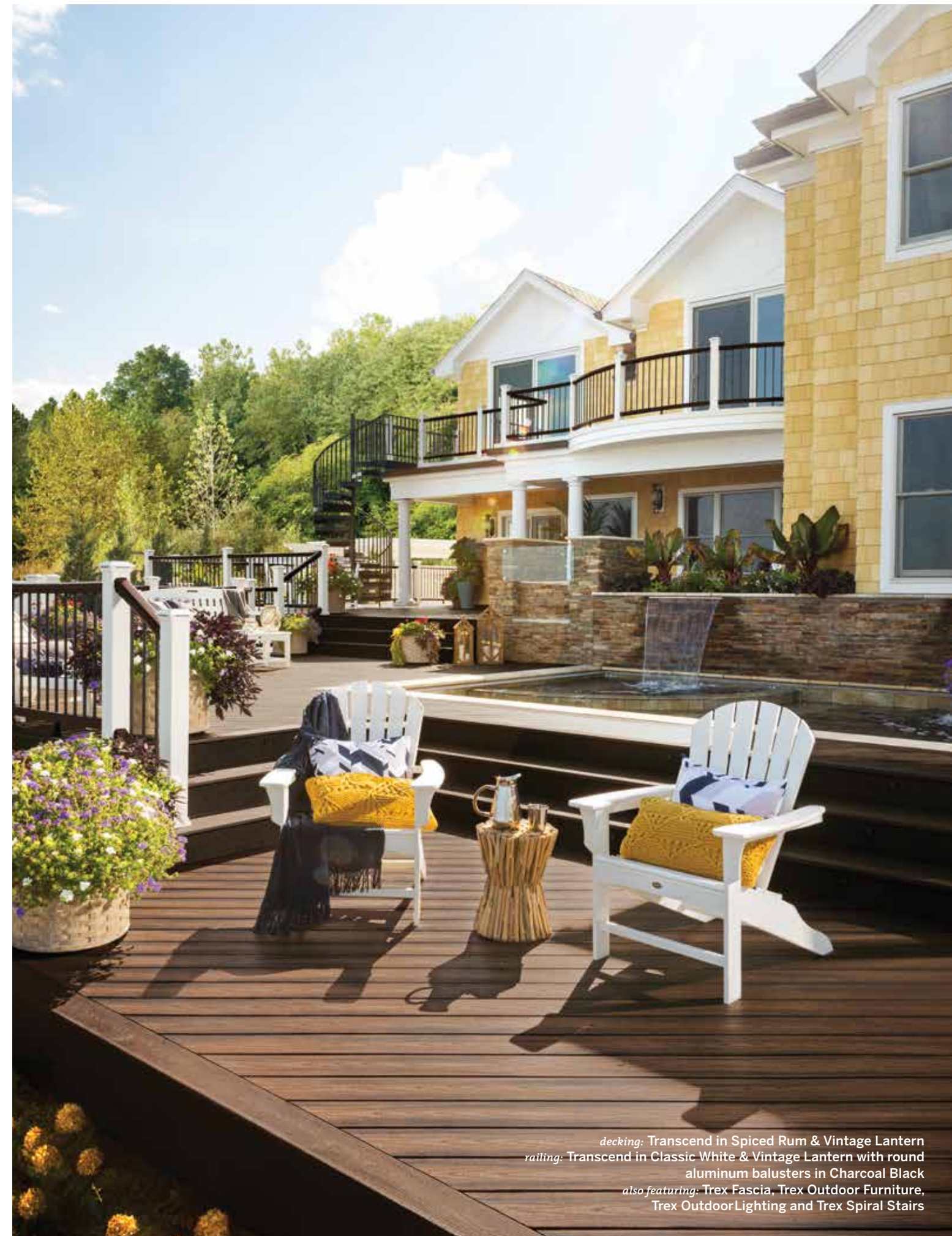

decking: Transcend in Spiced Rum & Vintage Lantern
railing: Transcend in Classic White & Vintage Lantern with round aluminum balusters in Charcoal Black
also featuring: Trex Fascia, Trex Outdoor Furniture, Trex Outdoor Lighting and Trex Spiral Stairs



MAKE IT LAST



- » Available in a wide range of colors that can complement any home and never need sanding, staining or painting
- » Won't rot, split, splinter or crack
- » Stain resistant and washes clean with just a little soap and water or power washing
- » Termite proof
- » Guaranteed to still look and feel great for 25 years
- » Made from 95% recycled materials

VS.

- » Requires constant upkeep and needs seasonal painting, staining or sealing
- » Becomes a safety hazard when it rots, splits and splinters
- » Stains easily and requires extensive work to clean
- » Termites' favorite food, the insects can cause extensive structural damage
- » Color fades over time
- » Contributes to deforestation



KEEP IT EFFORTLESS

There's more to the cost of a deck than just the cost of the boards. Factor in the stripping, sanding, staining, cleaning and yearly maintenance of wood and watch the costs add up before your eyes (not to mention in your garage). Just see how effortless and affordable Trex can be.



CREATE LUXURIOUS LOOKS

While all our decking lines provide the same high performance and low maintenance, each has its own aesthetic appeal and price point. These price differences pale in comparison to the cost of wood over 25 years, thanks to Trex's low-maintenance finish.



TREX TRANSCEND® BEST SELLER

- » 5 premium tropical hues with authentic color striations and a natural grain pattern
- » 5 classic earth tones in a deep grain pattern
- » More luxe design options; only slightly higher price

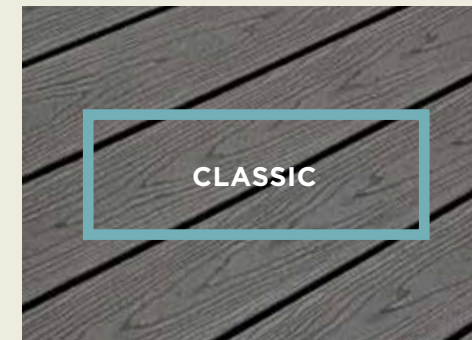

TREX ENHANCE®

- » 3 colors with a refined grain pattern
- » Wood-like look; mid-level price

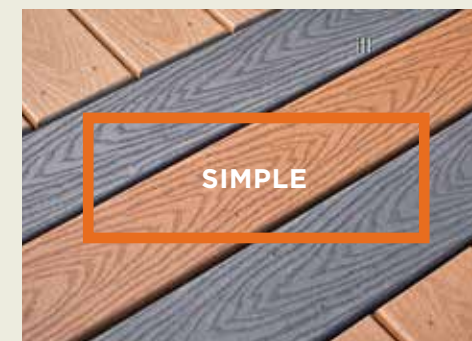

TREX SELECT®

- » 5 colors in a simple grain pattern
- » Easygoing style; entry-level price

TIP: In-stock decking is typically more affordable than special order. Choose your favorite, then go to [trex.com](https://www.trex.com) to find a dealer near you.



Estimate the cost of your project with our online cost calculator on [trex.com](https://www.trex.com)

Homes come in all hues
AND SO SHOULD DECKING AND RAILING.

Choosing from our spectrum of fade-resistant colors—in varying tones and wood-grain finishes—is the first step to creating a winning decking and railing combination.

TREX DECKING

	GREYS	BROWNS	REDS
TREX TRANSCEND PREMIUM TROPICALS	Island Mist	Tiki Torch	Lava Rock
TREX TRANSCEND CLASSIC EARTH TONES	Gravel Path	Rope Swing	Fire Pit
TREX ENHANCE	Clam Shell	Beach Dune	Madeira
TREX SELECT	Pebble Grey	Saddle	Woodland Brown
	Winchester Grey		

TREX RAILING

TREX TRANSCEND	Classic White	Rope Swing	Fire Pit
	Gravel Path	Tree House	Vintage Lantern
	Charcoal Black		
TREX REVEAL ALUMINUM RAILING	Classic White	Bronze	
	Charcoal Black		
TREX SELECT	Classic White		

ORDER A DECK BOARD SAMPLE



See how Trex will look in your outdoor space with a deck board sample sent straight to your home. All 18 of our decking colors are available online at **TREX.COM/SHOP**

CHOOSE *your* RAILING

When people look at your deck, they'll see the railing before anything else. Choose a design approach that fits your style and pairs well with your decking. To make it easier, we've created three ways to design picture-perfect railing. See how we coordinate, contrast and change it up to make decking & railing duos that really wow.

COORDINATE IT

Try a matching railing to make your deck feel cozy and well-coordinated.

CONTRAST IT

By introducing a new color in your railing, you can add a modern flair to your deck.

CHANGE IT UP

Go beyond the norm with some of these carefully curated combinations.



decking: Transcend in Island Mist
railing: Transcend in Classic White with Island Mist cocktail rail and square aluminum balusters in Charcoal Black
also featuring: Trex OutdoorLighting

One DECK, three WAYS

Your railing is just the start of your head-to-toe decking look. See how we coordinated, contrasted and changed up the railing for one of our favorite Transcend tropical decking colors, Tiki Torch, and all the chic styling that followed.

All featured Trex Outdoor Furniture Collections are available at trex.com

COORDINATE IT

Here a cocktail rail perfectly matches the deck board and balusters pick up the dark streaks in the wood grain. It all comes together for a classic, timeless yet modern look where every piece complements the other.



featuring: Trex Outdoor Furniture Surf City & Monterey Bay Collections

CONTRAST IT

Here the railing moves in the opposite direction of the decking—Classic White looks crisp against the deep brown. Alternately, if you choose a light decking board, you can achieve a contrasted look by selecting a darker color railing.



featuring: Trex Outdoor Furniture Parsons, Cape Cod & Rockport Collections

CHANGE IT UP

Here's where things get really daring. Dark aluminum railing and balusters complement the deck boards while contrasting with the Classic White post, creating a look that is a mixture of textures and colors—truly curated variety.



featuring: Trex Outdoor Furniture Rockport Collection 19

We coordinated, contrasted and changed up our entire Transcend tropical decking lineup. See a duo you love? Note the look number — **SR-1**
 You can get a full product list for each look at [trex.com/duos](https://www.trex.com/duos)

These mix well with
SPICED RUM



COORDINATE IT Rails: Classic White with Spiced Rum cocktail rail | Posts: Classic White
 Balusters: Classic White composite



SR-1



CONTRAST IT Rails: Charcoal Black aluminum | Posts: Vintage Lantern
 Balusters: Charcoal Black square aluminum



SR-2



CHANGE IT UP Rails: Vintage Lantern | Posts: Classic White | Balusters: Charcoal Black round aluminum



SR-3

Here's what really lights up
TIKI TORCH



COORDINATE IT Rails: Charcoal Black with Tiki Torch cocktail rail | Posts: Charcoal Black
 Balusters: Charcoal Black square aluminum



TT-1

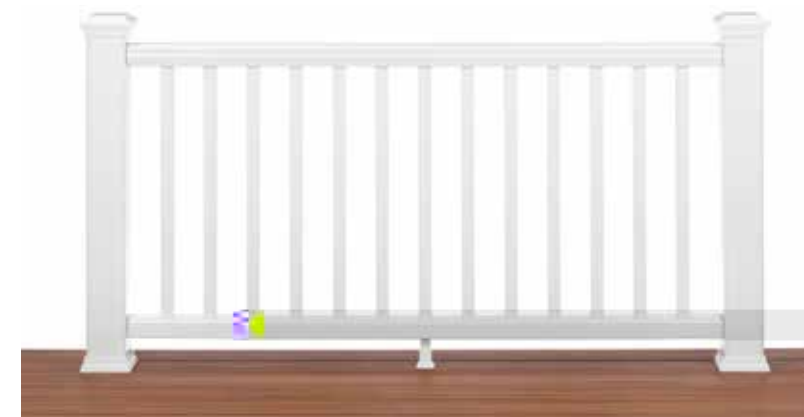

CONTRAST IT Rails: Classic White | Posts: Classic White | Balusters: Classic White composite



TT-2



CHANGE IT UP Rails: Bronze aluminum | Posts: Classic White | Balusters: Bronze square aluminum



TT-3

Meant to be with
ISLAND MIST

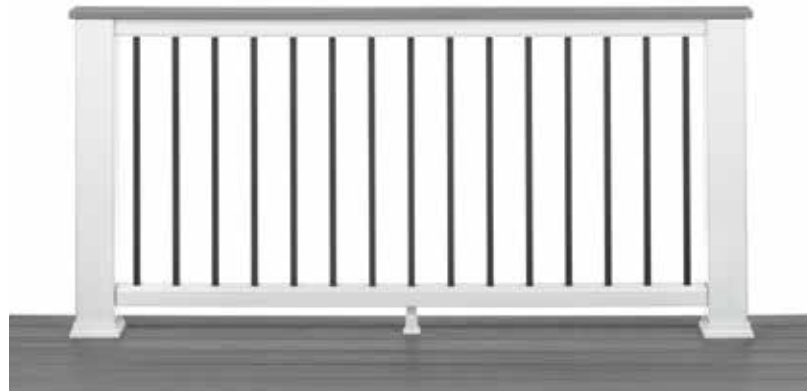

IM-1

COORDINATE IT Rails: Classic White with Island Mist cocktail rail | Posts: Classic White
Balusters: Charcoal Black square aluminum



IM-2

CONTRAST IT Rails: Classic White | Posts: Classic White | Balusters: Classic White composite

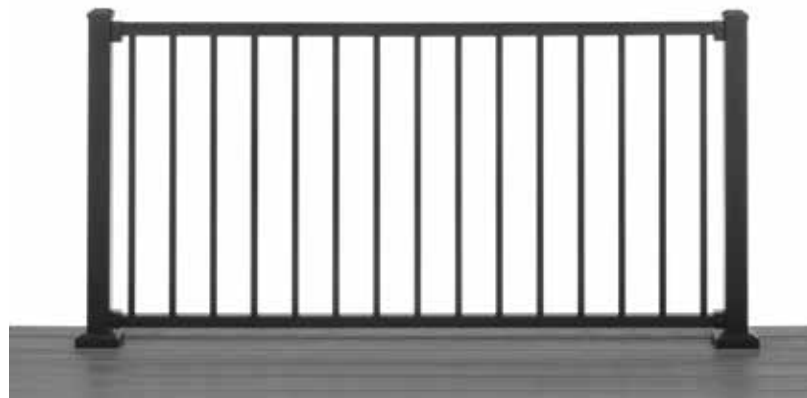

IM-3

CHANGE IT UP Rails: Charcoal Black aluminum | Posts: Charcoal Black aluminum
Balusters: Charcoal Black square aluminum

These all sparkle with
HAVANA GOLD

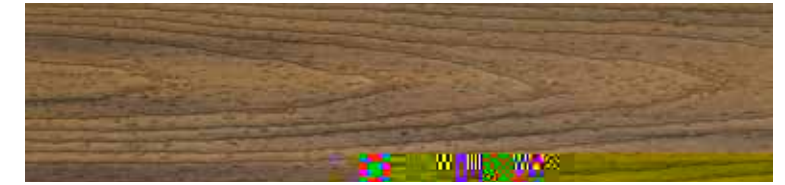

HG-1

COORDINATE IT Rails: Charcoal Black with Havana Gold cocktail rail | Posts: Charcoal Black
Balusters: Charcoal Black composite



HG-2

CONTRAST IT Rails: Charcoal Black aluminum | Posts: Charcoal Black
Balusters: Charcoal Black square aluminum



HG-3

CHANGE IT UP Rails: Vintage Lantern | Posts: Classic White | Balusters: Charcoal Black round aluminum

IM-1 — See a look you love? Get a full product list for the look at [trex.com/duos](https://www.trex.com/duos)

This is what gets hot with
LAVA ROCK



LR-1

COORDINATE IT Rails: Charcoal Black with Lava Rock cocktail rail | Posts: Charcoal Black
Balusters: Charcoal Black round aluminum



LR-2

CONTRAST IT Rails: Classic White | Posts: Classic White | Balusters: Charcoal Black round aluminum



LR-3

CHANGE IT UP Rails: Charcoal Black aluminum | Posts: Charcoal Black
Balusters: Charcoal Black square aluminum

LR-1 See a look you love? Get a full product list for the look at [trex.com/duos](https://www.trex.com/duos)

THE *custom route*

If you prefer a truly customized look for your deck, we've made it easy with an abundance of options for color, shape and building materials.

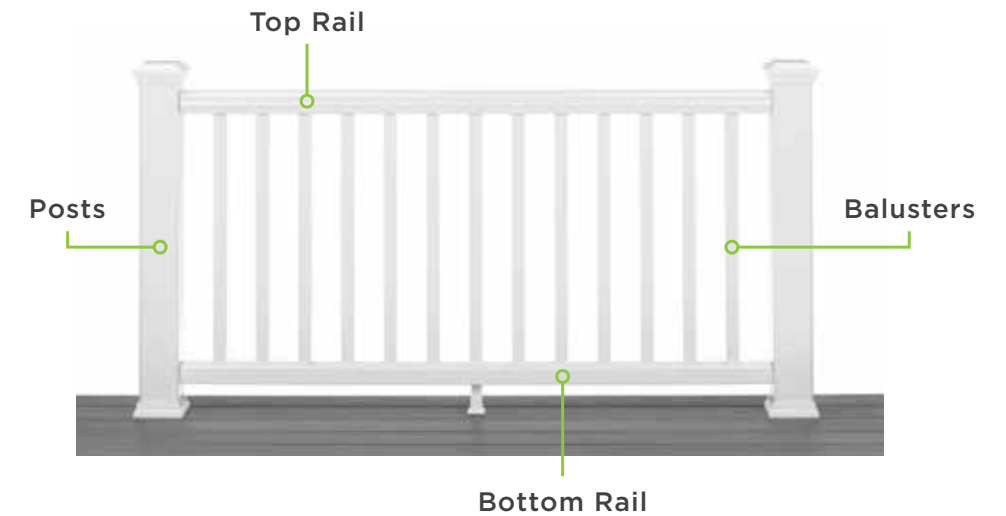

Posts

Vertical poles that can be outfitted with caps and skirts

AVAILABLE IN ALL COLORS



Rails

Top and bottom rails designed to keep railing straight and beautiful

AVAILABLE IN ALL COLORS



Balusters

Vertical balusters that maintain space and safety

AVAILABLE IN ALL COLORS



Cocktail Rail (Optional)

Deck board on universal top rail to create a flat surface

AVAILABLE IN ALL TREX DECKING COLORS

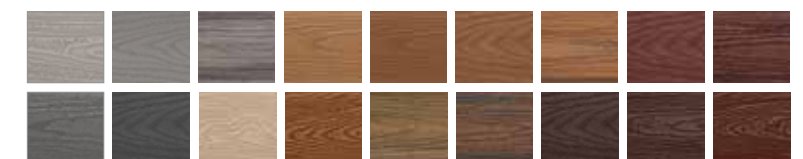

TREX COLOR GUIDE

Get inspired by all our decking & railing duos with the Trex Color Guide. Order yours at [TREX.COM/SHOP](https://www.trex.com/shop)

ADD THE *finishing touches*



Trex® Outdoor Furniture™

Stylish seating and dining collections built to last, conveniently available online at [trex.com](https://www.trex.com)

Built-in Seating

Convenient and durable through all weather

Trex® OutdoorLighting™

Easy to install and integrate into your decking, railing and surrounding landscape

Trex® Fascia

Gives a clean, polished look to stairs and sides of deck

Trex® Pergola™

A shaded oasis for your deck

Trex® OutdoorStorage™

Easily accessible storage that doesn't take up extra space and can be matched to your deck and customized to your needs

Trex Aluminum Gates

Made from the same strong and appealing materials as Trex railing, these gates are as easy to customize and install as they are to maintain



decking: Transcend in Tree House & Vintage Lantern
 railing: Transcend in Tree House with composite balusters in Vintage Lantern
 also featuring: Trex OutdoorLighting

FRAMING | DECKING | RAILING | LIGHTING | FASCIA | STORAGE | FURNITURE | PERGOLA | DRAINAGE



FIND US ON



Visit trex.com or call 1-800-BUY-TREX



© 2016 Trex Company, Inc. All rights reserved. Trex®, the Trex logo, Trex Elevations®, Trex Transcend®, Trex Enhance®, Trex Select®, Trex Reveal®, Trex® Outdoor Furniture™, Trex® OutdoorStorage™, Trex® Spiral Stairs™, Trex® OutdoorLighting™ and Trex® Pergola™, are either federally registered trademarks, trademarks or trade dress of Trex Company, Inc., Winchester, Virginia.