

Uniclic® is a glueless locking system that leads the flooring industry with its fast and effortless installation process. Its innovative design maintains pre-tension between planks, ensuring a tight joint and preventing unwanted gaps. Uniclic eliminates the need for adhesive, streamlining the installation process and making it quick and hassle-free.

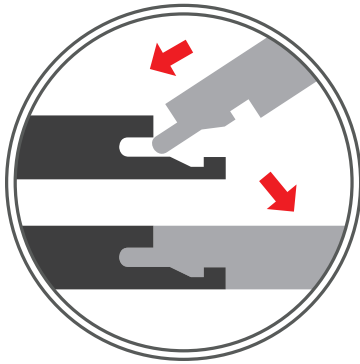

ENHANCED JOINT INTEGRITY

A tension system designed to eliminate any unsightly gaps between planks for decreased creaking and movement when walked on.

QUICK, EASY INSTALLATION

Easily install planks by snapping them together via an angle or horizontal installation method.

GLUELESS

No need for nails or any kind of adhesive to keep the planks together.



Scan here to
learn more.

UNICLIC — DURABLE PROFILE DESIGN

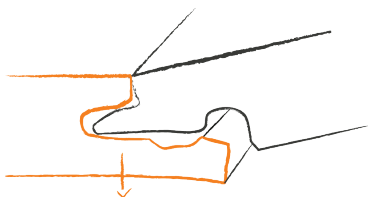

Flexible lower lip

No raised edges or height differences

Counters production deviations

No snapping



COMPETITOR

The Uniclic patented technology helps prevent the leading cause of flooring claims — click failure.

PROFILE TENSILE STRENGTH

HORIZONTAL LOCKING STRENGTH

How much horizontal force can the locking profile bear before disconnecting or breaking?

Our Uniclic locking system is over **1.5x stronger** than the most widely used competitor, helping prevent plank separation for a more beautiful floor.*

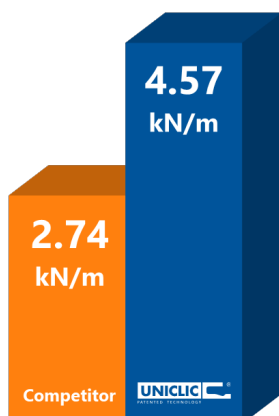

Tested on the exact same core material and thickness.

*Testing utilized profile tensile ISO 24334 on SPC core construction.

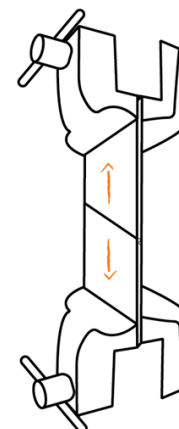

PROFILE TENSILE STRENGTH



CASTOR CHAIR

The test simulates the stress that flooring undergoes from repeated rolling or swiveling movements of castor chairs.

COMPETITOR



Broken locking system and raised edges.

Starts showing height differences above norm at 5,000 cycles.

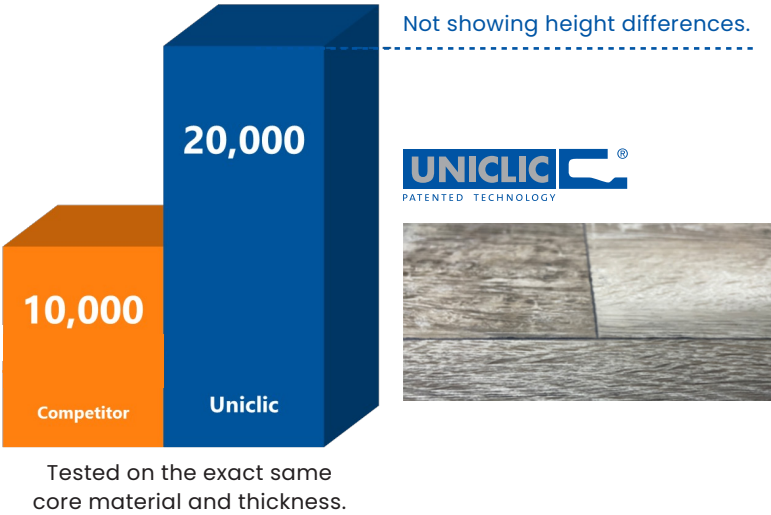

Our Uniclic locking system is **2x more durable** than the most widely used competitor product, helping prevent plank separation for a more beautiful floor.**

**Testing utilized castor chair EN ISO 4918 on SPC core construction.