

ASSEMBLY INSTRUCTIONS
ITEM NO :1834 Omega

Thank you for purchasing this quality product. Be sure to check all packing material carefully for small parts that may have come loose inside the carton during shipment.

Make sure to read the instructions below before assembling your power recliner

The power cord can be found attached to the power mechanism motor with a red wire tie. Remove the power cord from the motor and set it aside to be used later in step 5

Step 1 Position the KD back(B) with the KD receivers positioned over the mechanism post on the recliner body (E) as pictured below .

Check to assure both sides of the mechanism are positioned inside of the KD receiver on the back frame, push in a downward motion from the top of the back frame until a clicking sound is heard.

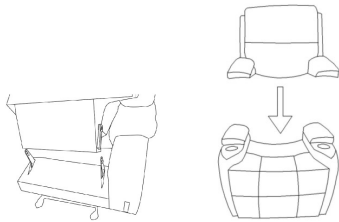

TOOLS REQUIRED : NO TOOLS REQUIRED			
PART LIST			
NO	Description	Sketch	Quantity
A	LAF/RAF KD Wing		1 each
B	Recliner Back		1
E	Recliner Body		1
F	Power cord		1

Step 2 Attach the 2 KD wings, one LAF and one RAF. Align the KD bracket on the wing(A) with the KD receiver on the back (B) as the picture below. Push in a downward motion from the top of the wing frame until until securely attached.

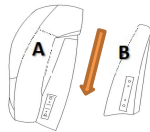

Step 3 Attach the leadwires found at the bottom of motion back to the leadwires at the rear of seat, Red to Red & Black to Black. Make sure to close the locks to assure the connections will not come loose during use

The lumbar leadwires can be identified by being wrapped with a piece of red tape

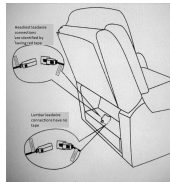

The headrest leadwire connections have no tape

Step 4 Attach outside back across the bottom rear of seat rail with the pre attached velcro

Step 5: After attaching KD back as noted in steps 3 & 4, attach the power cord to the power plug found at at the rear of the Left arm facing

After assembly is complete your product should look as seen below.



Do Not plug your recliner power cord into a power outlet until you recliner in completely assembled and in the location of its intended use

Notes:

1) To help prevent shock and or damage to your product only plug the power cord into a grounded outlet .The toggle switch at the rear of the arm will illuminate red when the product has power.

2) **Read the operating instructions carefully before operating your power recliner**

Operating Instructions for your Triple Power Recliner

Caution: Read the Important instructions below before operating your power mechanized equipment

Do not allow children to play on or operate this power mechanized equipment

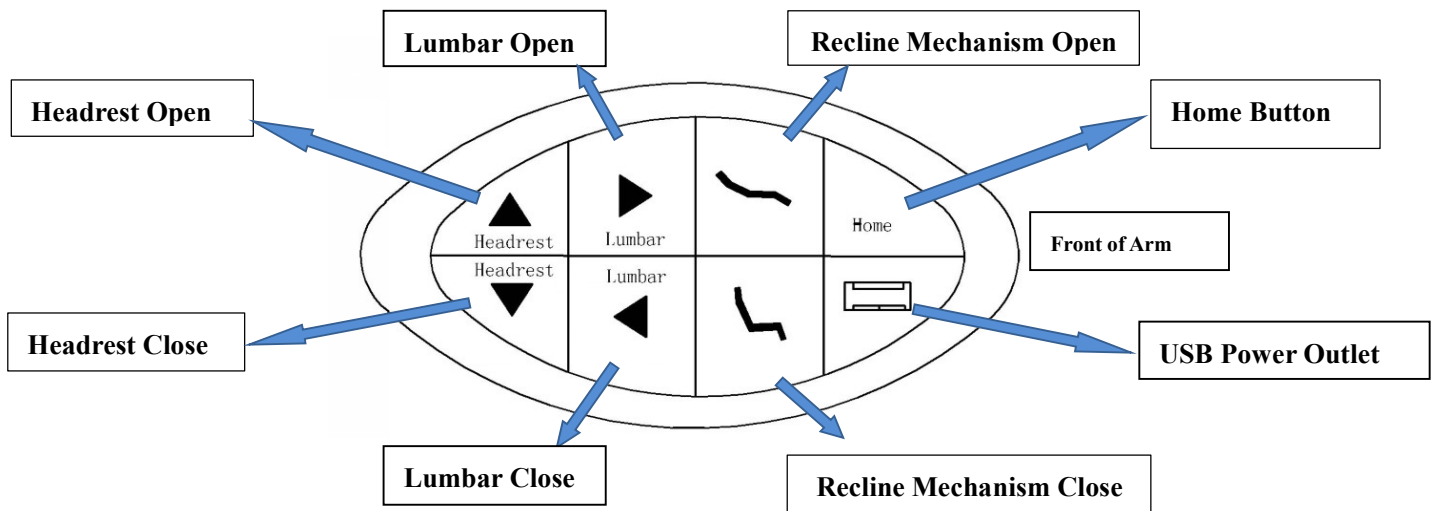

Home Button is Not Programmable

USB Power Outlet will charge most electronic devices

Care should always be taken to assure there is nothing in the path of the mechanism before and during operation

Open and Close Buttons

The open and close buttons will operate the function noted above by simply touching the button. To stop the mechanism in your desired position simply remove your finger from the button

Home Button

The Home button will close/return the headrest, lumbar and reclining mechanism to the closed position at the same time simply by pressing on the button. To stop the functions simply remove your finger from the button

5-25-18

HL Style 1834 Omega
HL Style 1842 Falcon