

ASSEMBLY INSTRUCTIONS

ITEM NO: BVC162-N NIGHTSTAND W/USB-MAYFAIR WHITE



Thank you for purchasing this quality product. Be sure to check all packing material carefully for small parts that may have come loose inside the carton during shipment.

WIRELESS CHARGING DIAGRAM

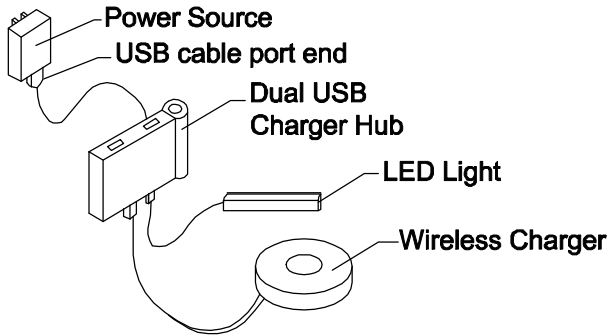

Wireless device is already installed into the underside of the night stand top, if you need to remove for any reason please twist locking device counter clockwise to remove, then re insert and lock by twisting the clockwise .

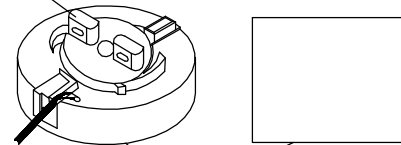

Lock / unlock .

CAUTION: Changes or modifications not approved by the party responsible for compliance could void user's authority to operate the equipment.

NOTE: This equipment has been tested and found to comply with the limits for a Class B digital device, pursuant to Part 15 of the FCC Rules. These limits are designed to provide reasonable protection against harmful interference in a residential installation. This equipment generates, uses and can radiate radio frequency energy and, if not installed and used in accordance with the instructions, may cause harmful interference to radio communications. However, there is no guarantee that interference will not occur in a particular installation. If this equipment does cause harmful interference to radio or television reception, which can be determined by turning the equipment off and on, the user is encouraged to try to correct the interference by one or more of the following measures:

- Reorient or relocate the receiving antenna.
- Increase the separation between the equipment and receiver.
- Connect the equipment into an outlet on a circuit different from that to which the receiver is connected.
- Consult the dealer or an experienced radio/TV technician for help.

Label shown is placed on the top to indicate wireless charging position . Place compatible device in this area for charging .

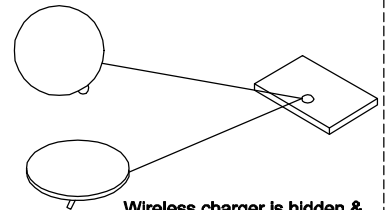

Wireless charger is hidden & mounted underneath top panel.

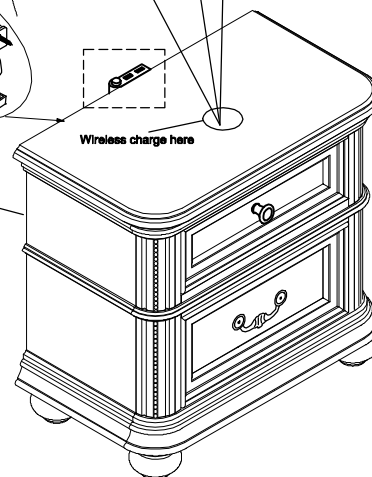
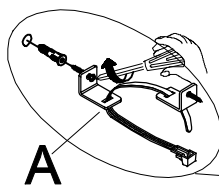

MADE IN VIETNAM