

## ASSEMBLY INSTRUCTIONS

ITEM NO: 60323

Power Recliner Fiero

**Thank you for purchasing this quality product. Be sure to check all packing material carefully for small parts that may have come loose inside the carton during shipment.**

**Care should be taken when assembling your Fiero power recliner. Please read the instruction carefully before assembling.**

Note that the only assembly required for your Fiero power recliner is to attach the KD Back.

The power transformer and lead wires come pre attached and can be located at behind the seat attached to the mechanism post.

**Step 1:** Locate and remove the power transformer from the mechanism post at the rear of the body.

**Step 2:** Attach the KD Back assembly by positioning the mechanism receivers located on each side of the KD Back over the mechanism posted located at the rear of the body as seen below. Once both receivers are positioned over the mechanism post push downward until a clicking noise is heard. The mechanism receivers have a spring lock which will securely hold the KD back assembly to the mechanism post when properly attached. And then connect headrest power cord as pictured below.

**Step 3:** Once the KD Back is securely attached to the mechanism you are ready to attach the outside back to the bottom of the body with the pre attached velcro.

**Step 4:** Note the power transformer should never be plugged into a power outlet until it is completely assembled and located where you will enjoy your power recliner.

**The Power Transformer should only be plugged in to a grounded power supply.**

**USB Charging Port:** The USB charging port will charge most electronic items. The USB cord is not included.

### PARTS LIST

A 2 Arm Recliner Body 1



B 2 Arm Recliner KD Back 1



C RAF Recliner Body 1



B RAF Recliner KD Back 1

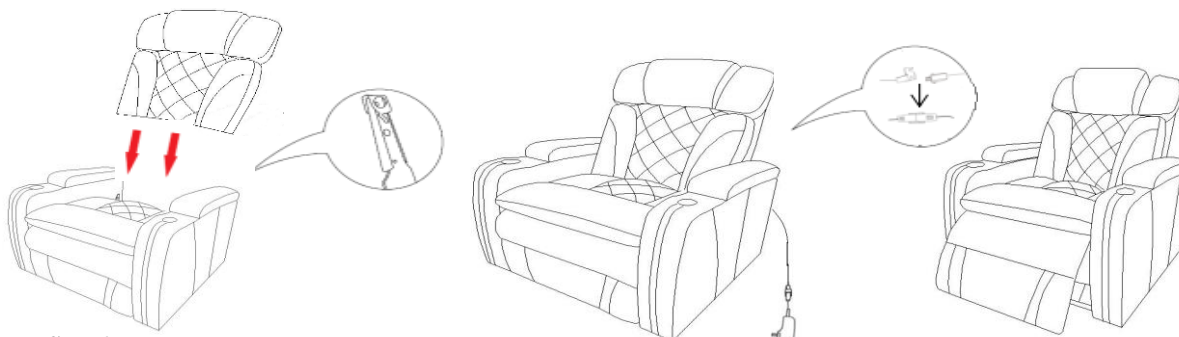

**Step 2**

Your Fiero Power Recliner was designed to be used as a free standing recliner or in a Home Theatre setting. If using in a Home Theatre setting its important to leave a gap between the Fiero Power Recliner and the Fiero RAF Recliner for the recliner to properly operate.

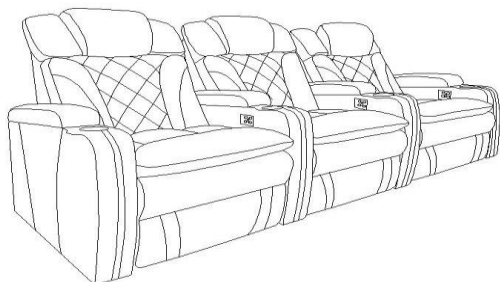

**Note that the cup holders should never be used as an ash tray and should be wiped clean periodically.**

**MADE IN CHINA**