



ASSEMBLY INSTRUCTIONS

ITEM NO: DVC100 CDC CANE BCK SIDE CHR-CHARLSTN WHT
DVC200 CDC CANE BACK CHR-CHARLESTON GRY

Thank you for purchasing this quality product. Be sure to check all packing material carefully for small parts that may have come loose inside the carton during shipment.

HARDWARE/PARTS LOCATION

DVC100/200 CDC > Step 1,2,3 & 4 hardware > Inside red pack with red tape > Placed at top corner carton
> Leg > Inside labeled inner carton > Placed on the seat cushion
> Stretcher > Inside labeled inner carton > Placed in seat cushion

TOOLS REQUIRED (NOT PROVIDED)

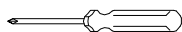

Screw Driver

PARTS LIST:

No.	Description	Sketch	Quantity
A	Chair Back		1 pc
B	Seat		1 pc
C	LSF/RSF Front Leg		2 pcs
D	Stretcher		2 pcs

HARDWARE LIST:

No.	Description	Sketch	Size	Quantity
E	Bolt		Ø5/16"L 76mm	4 pcs
F	Bolt		Ø5/16"L 44mm	7 pcs
G	Flat washer		Ø5/16"X19mm X2mm	11 pcs
H	Spring washer		Ø5/16"X12mm X2mm	11 pcs
I	Wood Crew		8X38mm	4 pcs
J	Allen wrench		4mm	1 pc
K	Allen wrench		4mm	1 pc

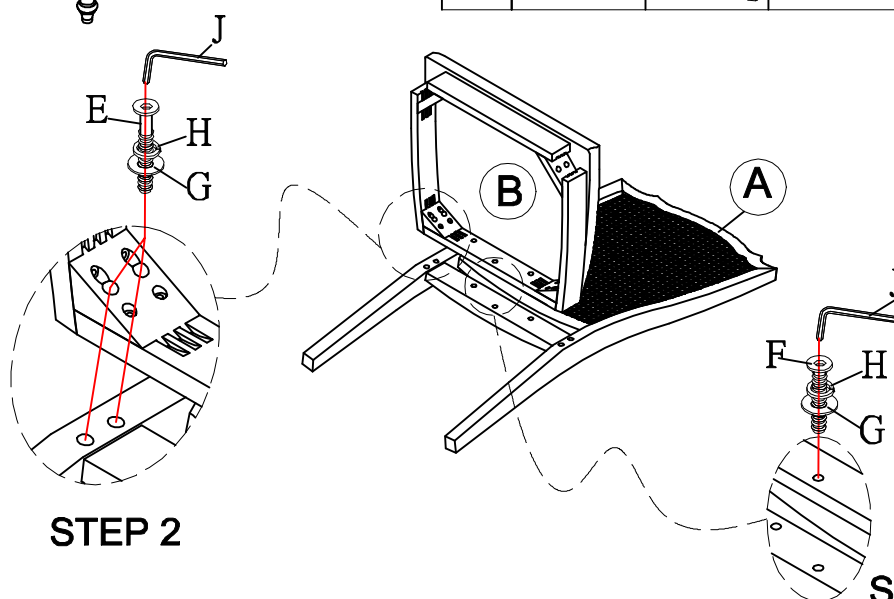
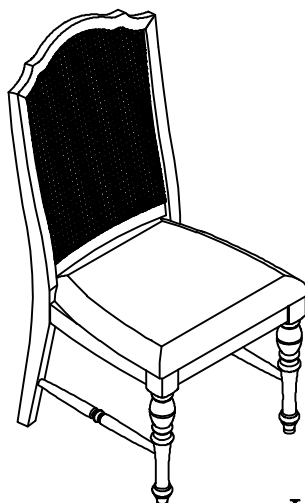

STEP 2

STEP 1

ATTENTION: DO NOT TIGHTEN ALL BOLTS UNTIL THE FINAL ASSEMBLY STEP.

MADE IN VIETNAM

ASSEMBLY INSTRUCTIONS

ITEM NO: DVC100 CDC CANE BCK SIDE CHR-CHARLSTN WHT
DVC200 CDC CANE BACK CHR-CHARLESTON GRY

Thank you for purchasing this quality product. Be sure to check all packing material carefully for small parts that may have come loose inside the carton during shipment.

HARDWARE/PARTS LOCATION

DVC100/200 CDC > Step 1,2,3 & 4 hardware > Inside red pack with red tape > Placed at top corner carton
> Leg > Inside labeled inner carton > Placed on the seat cushion
> Stretcher > Inside labeled inner carton > Placed in seat cushion

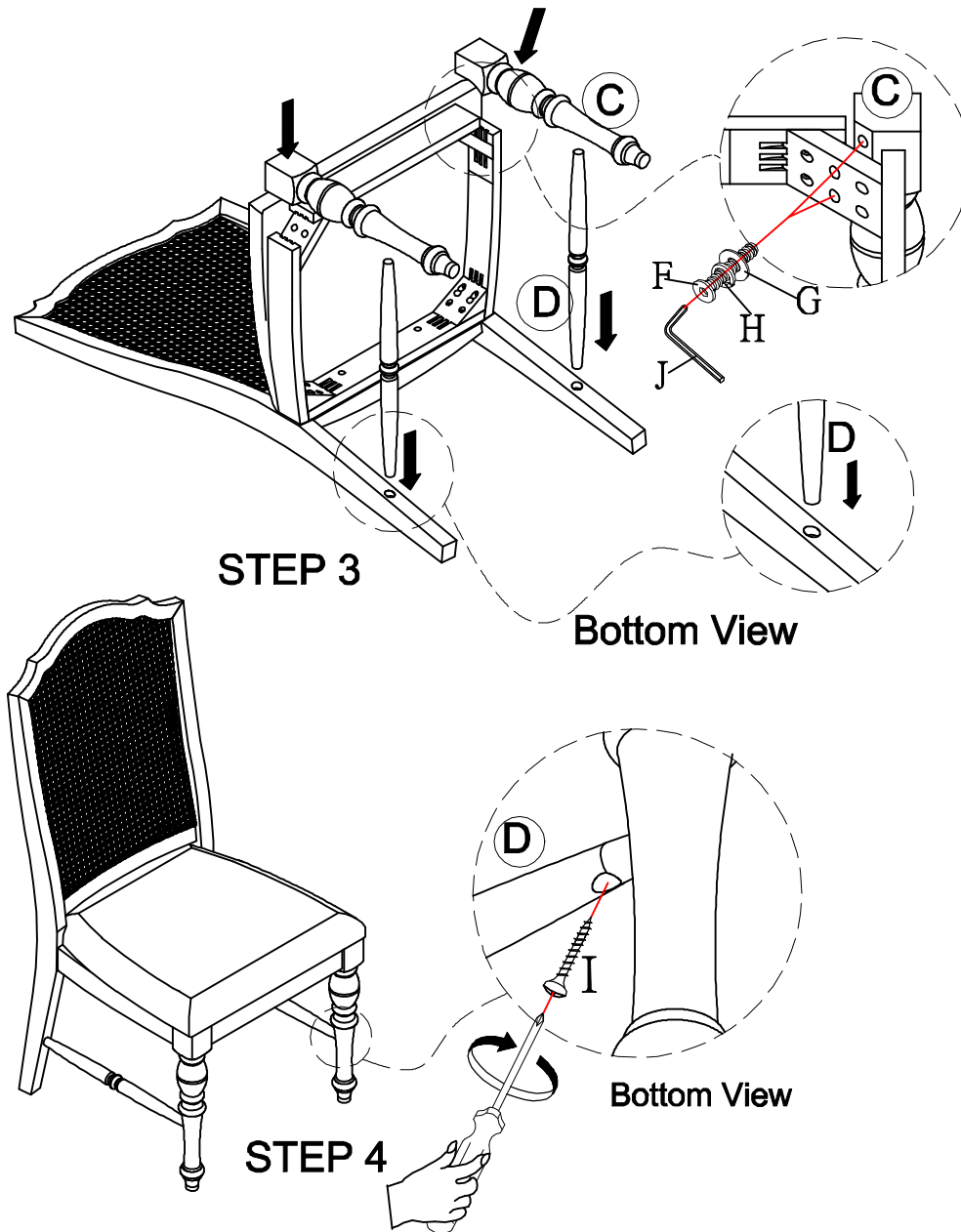

ATTENTION: DO NOT TIGHTEN ALL BOLTS UNTIL THE FINAL ASSEMBLY STEP.

MADE IN VIETNAM

EXCLUSIVE AMERICAN SIGNATURE DESIGN-DO NOT REPRODUCE WITHOUT WRITTEN PERMISSION