

ASSEMBLY INSTRUCTIONS

ITEM NO :1486 Bradley

Thank you for purchasing this quality product. Be sure to check all packing material carefully for small parts that may have come loose inside the carton during shipment.

Make sure to read the instructions below before assembling your power sofa

1)The power cord (E)can be found attached to the power mechanism motor with a red wire tie. Remove the power cord from the motor and set it aside to be used later in step 4

Step 1 Position the back(A/B/C) of your sofa with the KD receiver positioned over the mechanism as pictured below .

*Check to assure both sides of the mechanism are positioned inside of the KD receiver on the back frame, pushing in a downward motion from the top of the back frame until a clicking sound is heard.

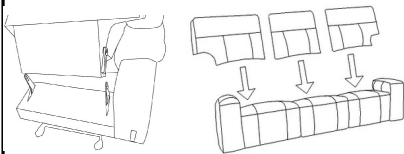

TOOLS REQUIRED : NO TOOLS REQUIRED

PART LIST

NO	Description	Sketch	Quantity
A	LAF sofa back		1
B	Mid sofa back		1
C	Raf sofa back		1
D	sofa body		1
E	Power cord		1

Step 2*

Attach the leadwires found at the bottom of motion back to the leadwires at the rear of seat, Red to Red & Black to Black. Make sure to close the locks to assure the connections will not come loose during use

The lumbar leadwires can be identified by being wrapped with a piece of red tape

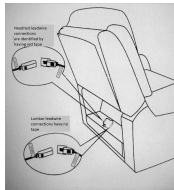

The headrest leadwire connections Black wire, have no tape

Step3*Attach outside back across the bottom rear of seat rail with the pre attached velcro

Step4*After attaching KD back as noted in steps 2 & 3, attach the power cord to the power plug found at the rear of the arm facing

After assembly is complete your product should look as seen below.

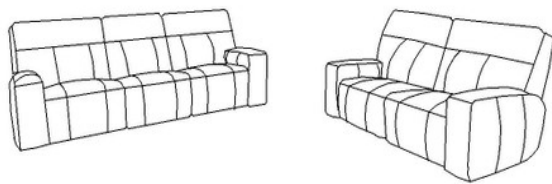

Do Not plug your recliner power cord into a power outlet until you recliner is completely assembled and in the location of its intended use

Notes:

- 1) To help prevent shock and or damage to your product only plug the power cord into a grounded outlet .The toggle switch at the rear of the arm will illuminate red when the product has power.**
- 2) Read the operating instructions carefully before operating your power sofa**

MADE IN CHINA

Operating Instructions for Triple Power Recliner

Caution: Read the Important instructions below before operating your power mechanized equipment

Do not allow children to play on or operate this power mechanized equipment

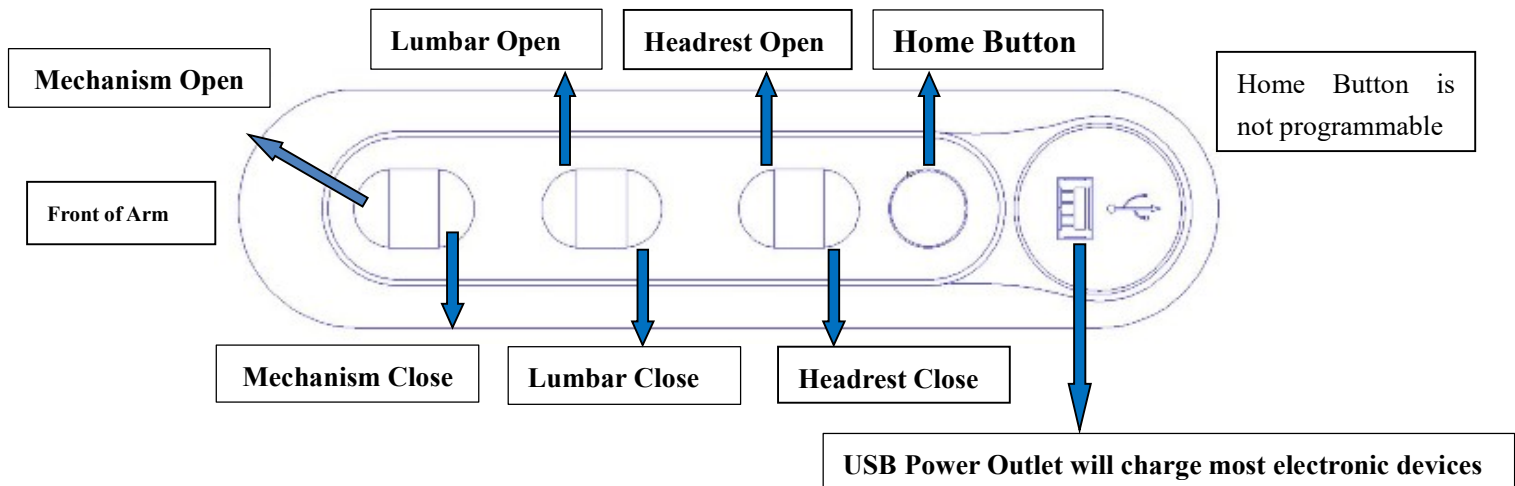

Care should always be taken to assure there is nothing in the path of the mechanism before and during operation

Open and Close Buttons

The open and close buttons will operate the function noted above by simply touching the button. To stop the mechanism in your desired position simply remove your finger from the button

Home Button

The Home button will close/return both the headrest and reclining mechanism to the closed position at the same time simply by pressing on the button. To stop the functions simply remove your finger from the button

6-8-17

Bradley 1486