

ASSEMBLY INSTRUCTION

ITEM NO. : ME700SV
SERVER-BANKS BLACK

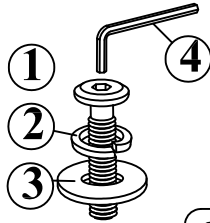

Thank you for purchasing this quality product. Be sure to check all packing material carefully for small parts that may have come loose inside the carton during shipment.



STEP 1

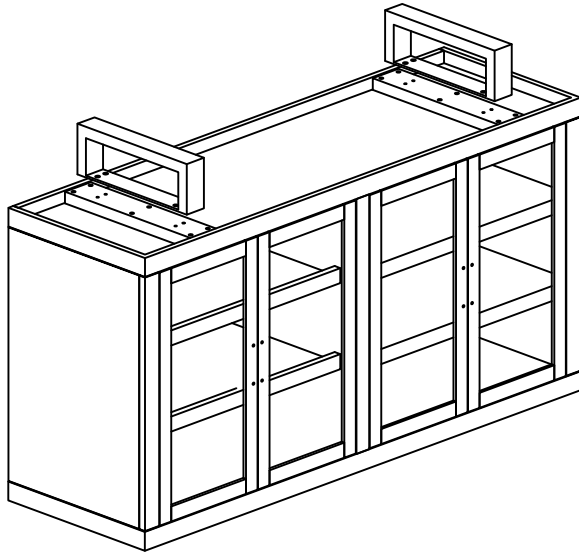

NO	PARTS LIST		QTY'
A	Server		1 pc
B	Metal Leg		2 pcs

HARDWARE LIST

NO.	DESC.	SKETCH	QTY'
1	Allen Bolt $\phi 1/4"$ x 25mm		8 pcs
2	Flat Washer $\phi 5/16"$ x 19mm		8 pcs
3	Lock Washer $\phi 5/16"$ x 13mm		8 pcs
4	Allen Key 4 mm		1 pc
5	Straight Allen Key 4 mm		1 pc
6	Tipping Restraint		1 set

Note : Straight Alen Key (5) is for use with a power drill.

STEP 5

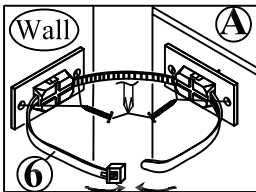

STEP 3

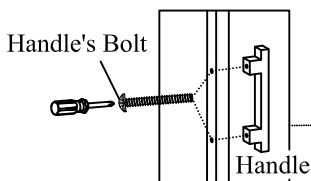
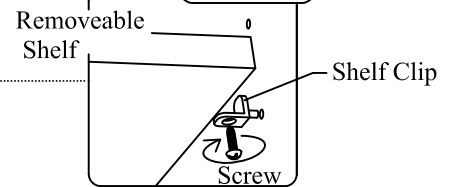

STEP 2

* Note : Open the Doors, remove the Handles by unfasten the Handle's Bolts and attach it to the outside of the Doors by using Phillips-head screwdriver (not provided) as the picture shown.

STEP 4

