

ASSEMBLY INSTRUCTIONS
ITEM NO: 61055/61155/62455
DESCRIPTION: SPLAT BACK SIDE
CHAIR- LANCASTER

Thank you for purchasing this quality product. Be sure to check all packing material carefully for small parts that may have come loose inside the carton during shipment.

Step 1: Place the Chair Back(A) on a padded surface, and assemble the Chair Seat(B) to the Chair Back (A), using the 1-1/2" long Bolts (D), Spring Washer (G), Flat Washer (H) in the middle of the back. Install the 3-1/4" long Bolts (F), using the same washers, into the back corners of the Chair Seat. Do not fully tighten any bolts until after the end of step 2.

Step 2: Assemble the Front Legs(C) to the Chair Seat using the 2-1/4" long Bolts (E), and same washers as before. Set the assembled Chair upright on a flat surface to level chair.

Step 3: Tighten all Bolts using the Allen Wrench.

PARTS LIST:

No.	Description	Sketch	Quantity
A	Chair Back		1 pc
B	Chair Seat		1 pc
C	Front Leg		2 pcs

HARDWARE LIST:

No.	Description	Sketch	Size	Quantity
D	Allen Head Bolt		M5/16" x 1-1/2"	1pc
E	Allen Head Bolt		M5/16" x 2-1/4"	4pcs
F	Allen Head Bolt		M5/16" x 3-1/4"	4pcs
G	Spring Washer		5/16"	9pcs
H	Flat Washer		5/16"	9pcs
I	Allen Wrench		5mm	1pc
J	Straight Allen Wrench		5mm	1pc

Note: If the straight Wrench (J) is used in a power drill, use care to not overtighten Bolts and possibly damage parts.

STEP 1

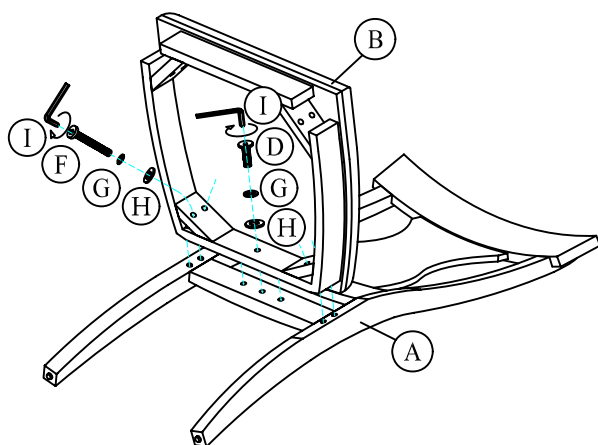

STEP 2

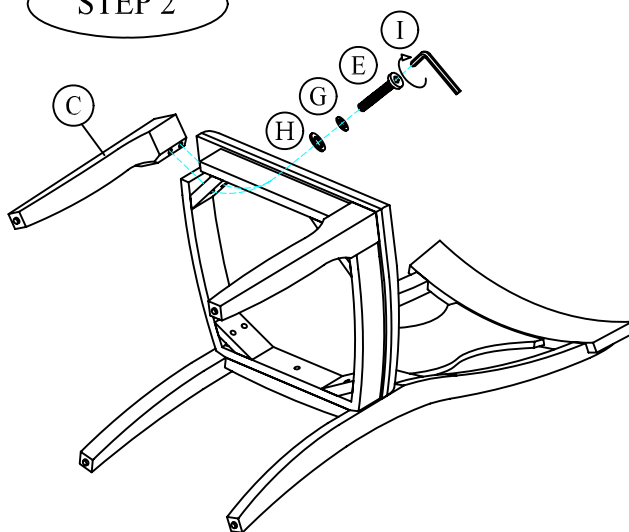

MADE IN CHINA