

ASSEMBLY INSTRUCTIONS

ITEM NO.: 61048

DESCRIPTION: DISPLAY CABINET-LANCASTER TRFF

ASSEMBLY INSTRUCTIONS

ITEM NO.: 61149

DESCRIPTION: DISPLAY CABINET-LANCASTER PRCH

Thank you for purchasing this quality product. Be sure to check all packing material carefully for small parts that may have come loose inside the carton during shipment.

Note:

There are two different, separately controlled, light fixtures installed in this Cabinet. All electrical wiring has been pre-tested at the factory before the Cabinet was packed and shipped. Please refer to Page #2 for detailed set-up and operation of the lighting.

1. The Adjustable Wood Shelf Frames (B) have been installed in the Cabinet for shipping. After moving the Display Cabinet to it's final location in the room, remove the wood screws securing the shelves to the shipping pins, move to the pins and Wood Shelf Frames to the desired position.
2. Place the Glass Shelves (C) into the two Adjustable and one Fixed Shelf Frames.
3. Hook the Oval Crystal Pendants (D) and Round Crystal Pendant (E) onto the Chandelier as shown.

PARTS LIST:

No.	Description	Sketch	Quantity
A	Display Cabinet		1 pc
B	Adjustable Wood Shelf Frame		2 pcs
C	Glass Shelf		3 pcs

HARDWARE LIST:

No.	Description	Sketch	Quantity
D	Oval crystal pendant		6 pcs
E	Round crystal pendant		1 pc
F	LED Light Bulb		6 pcs
G	Furniture Tipping Restraint Kit		1 pc

Note: The Furniture Tipping Restraint has been stapled to the back of the display cabinet.

Furniture tipping Restraint(G)



STEP 1

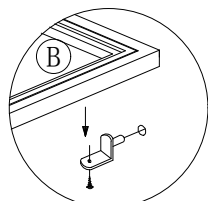

Adjustable shelf frame

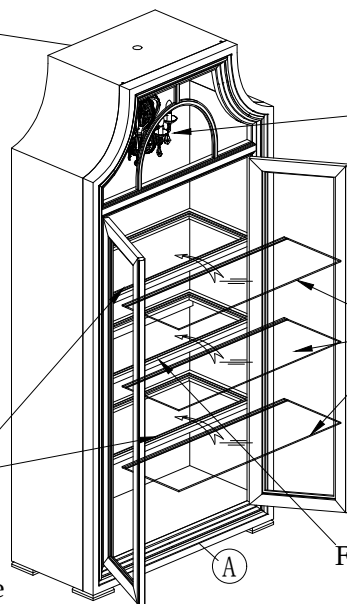

STEP 2

Fixed shelf frame

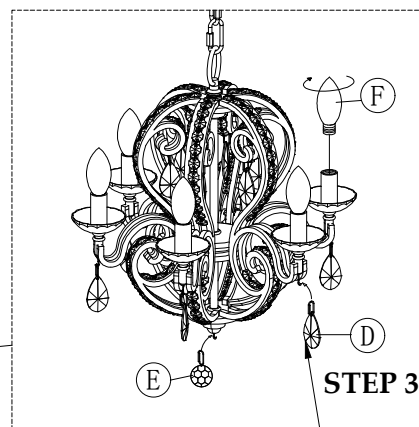

STEP 3

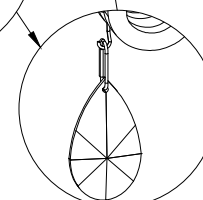
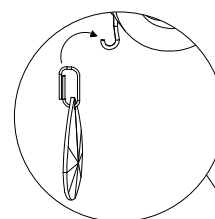

MADE IN CHINA

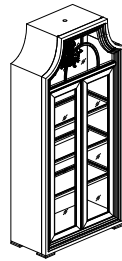

ASSEMBLY INSTRUCTIONS

ITEM NO.: 61048

DESCRIPTION: DISPLAY CABINET-LANCASTER TRFF

ASSEMBLY INSTRUCTIONS

ITEM NO.: 61149

DESCRIPTION: DISPLAY CABINET-LANCASTER PRCH

4. Install the six LED lamps (F) into the sockets of the Chandelier.
5. The lamps of the Chandelier are controlled by the Rotary on-off / dimmer switch mounted behind the left side of the Front Frame, above the door.
6. There are LED Strip lights mounted vertically behind both the Left and Right sides of the Front Frame. These are activated by touching the top hinge of the Right-Hand Door.
7. Plug the cord of both fixtures into a working electrical wall outlet.

The lights in these cabinets are very energy efficient Light Emitting Diode (LED) fixtures which are engineered to have a normal life expectancy of several years when used in a typical home. If any light fails to operate, verify there is power to the wall receptacle and check all electrical wiring connections to verify all are securely connected together.

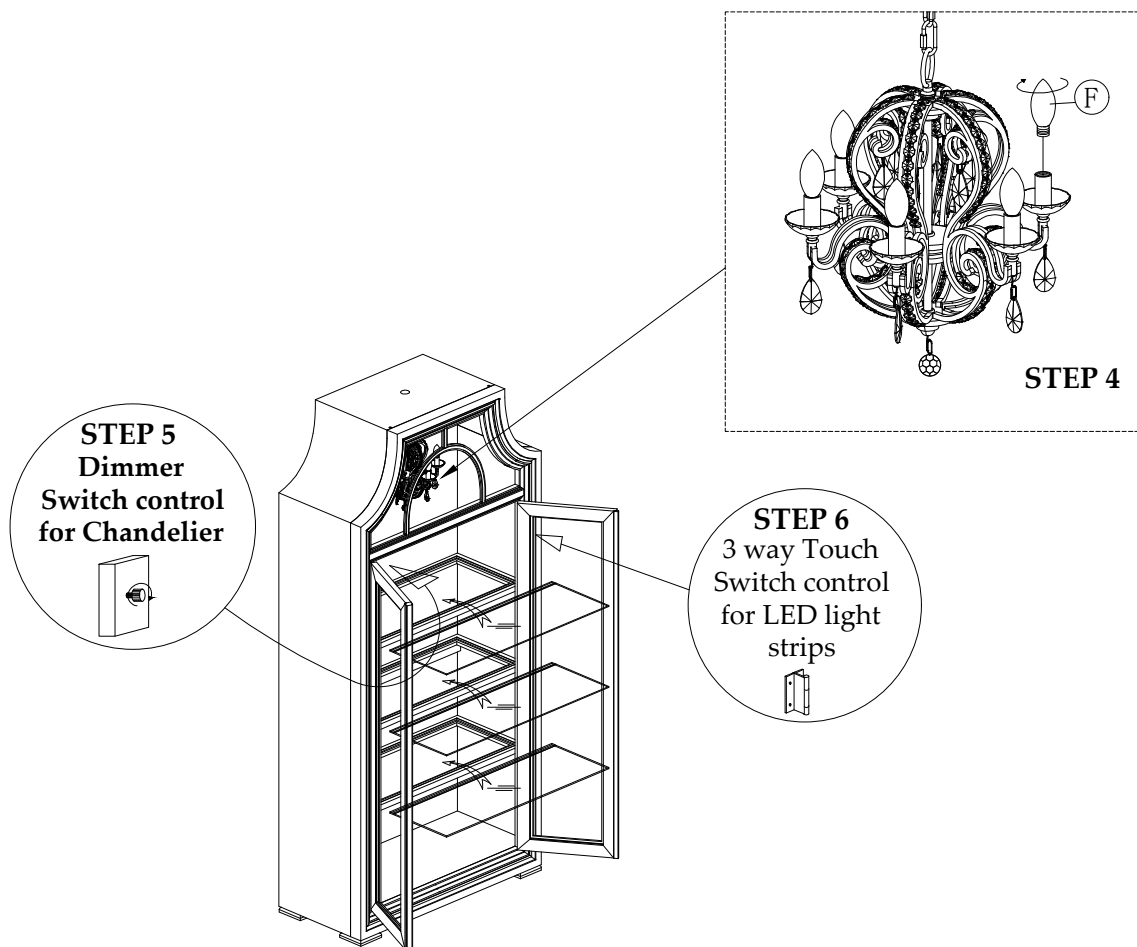

There are levelers located on the bottom of the feet which can be adjusted to compensate for uneven flooring if needed.

MADE IN CHINA

Furniture Tipping Restraint Installation Instructions

Notice: In homes where small children may be present, recommends that steps be taken for certain furniture items to prevent or minimize the risk of tip-over. This furniture is equipped with Tip-over Restraint Hardware for use to minimize this risk, if used. Please follow below installation steps. Recommends that parents and guardians periodically visit the U.S. Consumer Product Safety Commission (CPSC) website at <http://www.cpsc.gov/> and stay up to date on all issues related to children's product safety.

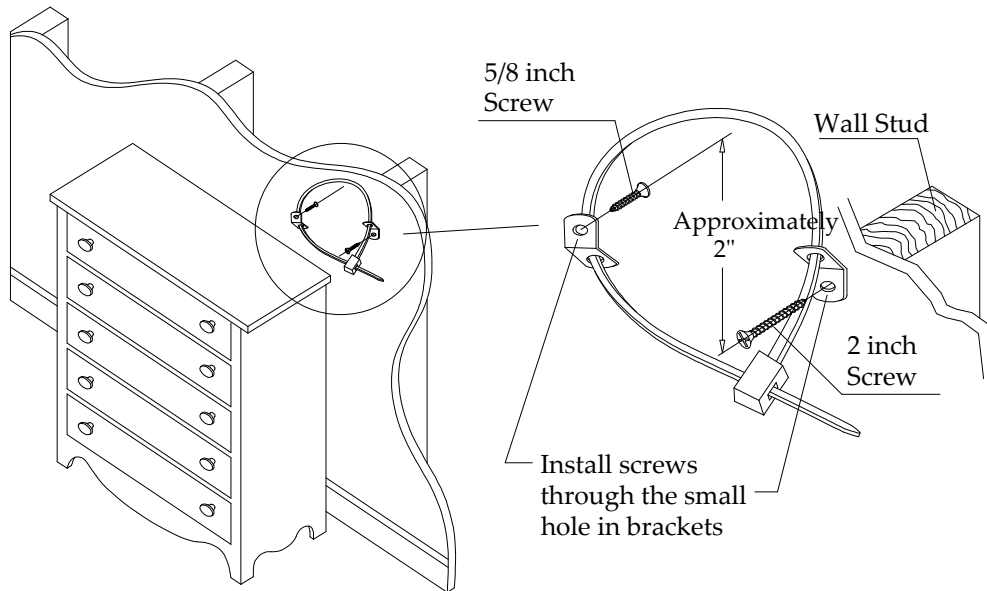

1. Temporarily locate the furniture to near it's final location in the room next to a wall. Locate a wall stud behind your furniture and also mark the stud's location on the back of your furniture.
2. Firmly attach one bracket to the stud approximately 2" below the top of the furniture with the 2 inch long Wood Screws provided. It may be necessary to drill 3/32 dia. pilot holes for the screws.
3. Firmly attach the other bracket onto a solid, structural part on the back of the furniture using the 5/8 inch long Wood Screws. It may also be necessary to pilot bore for these screws.
4. Move the furniture into its final position, taking care to line up the wall bracket with the furniture bracket. Thread a strap through the bracket as shown in the illustration. Tighten strap until snug but do not over tighten.

Caution: We assumes no liability for improper installation or excessive loads placed on screws, brackets or straps. Failure to detach this restraint before moving furniture may result in personal injury and property damage.

Warning: This tip-over restraint is not to be a substitute for proper adult supervision. Do not allow children to climb on furniture. Items left on top of the TV and furniture, such as toys, remote controls and treats might tempt young children to climb. Push the TV as far back as possible from the front of its stand. Place electrical cords out of a child's reach, and teach children not to play with the cords.